

2019 Onsite Guide / March 31 - April 3



Better
TOGETHER

CEM **RD** Academic Assembly

SEATTLE, WASHINGTON



Mentoring
Collaboration
Coaching



COUNCIL OF RESIDENCY DIRECTORS IN EMERGENCY MEDICINE

www.cordem.org/aa

#CORDAA19

CORD CLOSING
RECEPTION

MUSEUM — OF POP — CULTURE



Better
TOGETHER

CORD Academic Assembly

SEATTLE, WASHINGTON



TUESDAY - APRIL 2ND - 6:00 PM

325 5th Avenue N | Seattle, WA 98109

MoPOP is easily accessible by ride share service, taxi, and the historic
Seattle Center Monorail located 5 minutes from the Hyatt hotel

Your Academic Assembly Badge is your Admission Ticket

Program Contents

Conference Summary and Objectives	4
Welcome to Seattle	5
Thank You	6-7
Disclosure of Relevant Financial Information with Commercial Companies	8-10
Award Recipients	11
Conference Schedule by Day	14-21
Hotel Floor Plans	22-23
Committee Meetings Schedule	25
Afternoon Tours	26
Safari Dinners	26
Course Descriptions	28-42
Oral Abstract Presentations Schedule	44
Index of Conference Abstracts	45-47
Poster Moderators	48
EMRA Schedule of Events	49
Advertising	50-63
Next Year in NYC	64

CORD 2019-2020 Board of Directors

Maria Moreira, MD President	Alison Beaulieu, MD Resident-Member-at-Large	Jessica Smith, MD Member-at-Large
Fiona Gallahue, MD President-Elect	Boyd (Bo) Burns, DO Member-at-Large	Moshe Weizberg, MD Member-at-Large
Christopher Doty, MD Immediate Past President	Danielle Hart, MD Member-at-Large	Marianne Haughey, MD Member-at-Large
Tiffany Murano, MD Secretary/Treasurer	Diane Rimple, MD Member-at-Large	Michele Adair-Russo, C-TAGME EMARC Liaison

CORD Staff

Michele Byers, CAE, CMP Executive Director	DeAnna McNett Operations Manager	Leah Stefanini, CMP Conference and Event Manager
Tina Odisho Greenwood Communications Coordinator	Lisa Tolley Administrative Coordinator	

CONFERENCE SUMMARY

The optimal education and assessment of medical students, emergency medicine residents, and emergency medicine fellows, and the effective management of emergency medicine residencies and educational programs are continuously evolving processes. Teaching to adult learners who have grown up in the technological age requires innovative didactic and assessment tools and an understanding of best practices in teaching and assessment. It is also necessary to respond effectively to an increasingly complicated regulatory environment, including the ACGME's Next Accreditation System, the institution of Milestone-based competency assessment, and the increasing focus on Patient Safety and Quality Improvement initiatives.

Residency and student management demands multiply every year. Maintaining professional and personal balance and successfully advancing a career focused on education in emergency medicine is a constant challenge. Collaboration between emergency medicine programs, specialties, national emergency medicine organizations and accreditation associations facilitates and enhances resident and medical student education, assessment, and program management. The **2019 CORD Academic Assembly** will provide a spectrum of expert panel discussions, didactic sessions, interactive small group breakouts, research presentations, and consensus working groups, all specifically designed by and for educators in emergency medicine to address the needs of our unique teaching environment. It will also have a focus on mentoring, collaboration and coaching of faculty, residents, fellows and medical students.

CORD AA 2019 Better Together — Mentoring, Collaboration, Coaching

OBJECTIVES

Upon completion of this conference, emergency physicians and program coordinators will:

1. Incorporate milestones-based assessment tools into the training of emergency medicine residents.
2. Improve the written and verbal assessment and remediation of medical students and emergency medicine residents.
3. Incorporate advances in online learning, small-group discussion and lecture design, simulation and emerging technology to more effectively educate medical students and emergency medicine residents.
4. Discuss methods to support faculty development, promotion and life/career balance in academic emergency medicine.
5. Share cutting edge educational research and innovations and develop the skills to perform high quality educational research.
6. Review the latest RRC-EM updates, program requirement revisions and best practices in resident and medical student education.
7. Incorporate novel educational innovations, teaching methodologies and curricula to enhance the experience of emergency medicine resident and student learners.

CONTINUING EDUCATION CREDIT

This activity has been planned and implemented in accordance with the accreditation requirements and policies of the Accreditation Council for Continuing Medical Education (ACCME) through the joint provider-ship of the American College of Emergency Physicians and the Council of Residency Directors in Emergency Medicine. The American College of Emergency Physicians is accredited by the ACCME to provide continuing medical education for physicians.

The American College of Emergency Physicians designates this live activity for a maximum of 21.5 AMA PRA Category 1 Credit(s)™. Physicians should claim only the credit commensurate with the extent of their participation in the activity.

Approved by the American College of Emergency Physicians for a maximum of 21.5 hour(s) of ACEP Category I credit.

To access the Handouts, and Evaluations for the sessions, download the CORD Academic Assembly 2019 /app or visit cordem.org/HandoutsEvals. Click on the Handout or Evaluation links for the session of your choice.

Welcome from the Chairs

On behalf of the CORD *Academic Assembly* Planning Committee, it is with great pleasure and honor that we welcome you to Seattle, WA for the 2019 CORD *Academic Assembly*. This year our conference theme is *Better Together*, and as you know, this is also CORD's 30th anniversary. We are very excited to celebrate with all of you and we hope that you enjoy beautiful Seattle and all that it has to offer.

CONFERENCE HIGHLIGHTS

Keynote Address by Dr. Judith Tintinalli

What better way to celebrate our 30th anniversary than to hear, Dr. Judith Tintinalli, the first President of CORD, as our prestigious keynote address? Join us on Day One from 1:30-2:30pm in the Regency Ballroom, 7th floor.

Emphasis on Coaching, Mentoring, Diversity and Inclusion

In line with our theme of *Better Together*, there will be new speaker coaching and a focus on mentoring that highlights our unique ability to collaborate, mentor and help one another within CORD. Don't miss the CDEM focused session on mentoring URM, LGBTQ and women EM applicants on Day Three.

Inclusion and Diversity

The *Better Together* theme also applies to inclusion and diversity. CDEM will be having a focused session on mentoring URM, LGBTQ and women EM applicants, and similar sessions will be found throughout the programming in various tracks.

EMRA Event

EMRA events continue to deliver amazing programming for your residents. Must attend events include Quiz Show, Chaos in the ED, EMRA Representative Council Meeting & Townhall, and the EMRA Party, it promises to be an exciting and fun time.

Chief Resident Symposium

Will your new Chief Residents be prepared for their new role? They will be if they attend the Chief Resident Symposium at CORD! The symposium is in its third year at Academic Assembly and provides your Chiefs with the leadership and management skills necessary to have a very successful chief year.

Tracks, Tracks, Tracks!

The tracks you love are back!

- Best Practices integrates the best resources and ideas for educational programs in EM.
- Navigating the Academic Waters targets junior faculty providing development, mentorship, and advice to help advance career goals.
- Interested in how technology and education intersect? iMedEd is the track for you.
- New Programs and Leaders targets faculty who are new to leadership positions in EM education. They provide you with all the tools necessary to be great in your new role.
- Clerkship Directors in Emergency Medicine (CDEM) provides you with indispensable tools to enhance your Undergraduate Medical Education.
- The Resident Track is back with amazing programming targeting residents. If you are a resident considering a career in education, this is where you need to be!
- The EMARC track has new and amazing programming to make your job as a program administrator even better than it already is!
- Advances in Education Research and Innovations hosts moderated e-poster sessions and highlights some of the best research in the Best of the Best!

Themed 340 and 560 sessions

In addition to the great track programming, we offer a series of focused 560 sessions designed to address hot topics. Come join these high yield short talks and leave with lots of new ideas to take home to your program.

CPC

The two half day CPC semi-finals allows everyone an opportunity to attend CPC and still participate in other exciting CORD programming. Think you have what it takes? Try to solve the diagnosis!

Free Afternoon

Day Two continues in the tradition promoting wellness by scheduling a free afternoon to explore the Emerald City. Haven't made plans? Check with the CORD Customer Service Desk to register for one of three fun city tours — hurry as space is limited. Enjoy some free time with your program's team members, family or friends, or just take an afternoon off for yourself. Go ahead, you deserve it!

As always, there are many opportunities for networking at CORD Academic Assembly — extended time for networking lunches (be sure and pick up your VISA gift card at the CORD Customer Service Desk), Safari Dinners, a rocking Closing Party at the Museum of Pop Culture (MOPOP) and so much more!

We look forward to seeing you in Seattle!

Jan Shoenberger, MD & Dan Egan, MD

Co-Chairs, *Academic Assembly* Program Committee

Thank you!

**...to the many
dedicated people
who worked diligently
to help make this
event a reality!**

Conference Chairs



Jan Shoenberger, MD

Los Angeles County USC Medical Center



Dan Egan, MD

New York Presbyterian

Track Chairs

Caitlin Bailey, MD

Alameda County Medical Center/Highland General Hospital

Rebecca Bavolek, MD

UCLA Emergency Medicine-Ronald Reagan/Olive View

Sharon Bord, MD

Johns Hopkins University

Jeremy Branzetti, MD

NYU Bellevue Hospital Center

Bo Burns, DO

University of Oklahoma

David Duong, MD

Alameda County Medical Center/Highland General Hospital

Mikki Floring

Maricopa Medical Center

Michael Gottlieb, MD, RDMS

Rush University Medical Center

David Haidar, MD

University of Michigan St. Joseph Mercy Hospital

Leslie Oyama, MD

University of California, San Diego

Sara Paradise, MD

University of California, Irvine

Kendra Parekh, MD

Vanderbilt University Hospital

Jana Ricker

Maine Medical Center

Jordan Spector, MD

Boston Medical Center

Jeff Siegelman, MD

Emory University School of Medicine

Gina Waight, MD

New York Presbyterian

Jason Wagner, MD

Washington University in St. Louis

Fareen Zaver, MD

University of Calgary

Planning Committee

Linette Archer, MD

Marietta Memorial Hospital

Brian Bausano, MD

Washington University in St. Louis

Michele Byers, CAE, CMP

Executive Director, CORD

David Carlberg, MD

Georgetown University Hospital

Washington Hospital Center

Jonathan Fisher, MD

Maricopa Medical Center

Kathy Hiller, MD, MPH

University of Arizona

DeAnna McNett

Operations Manager, CORD

Tiffany Moadel, MD

North Shore University Hospital

Brooks Obr, MD

University of Iowa

Thomas Perera, MD

Long Island Jewish Medical Center

Stephanie Pollack, MD

Northwell Health

Cynthia Price, MD

University of Connecticut

Osman Sayan, MD

New York Presbyterian

Leah Stefanini, CMP

Conference and Event Manager, CORD

Ted Stettner, MD

Wellstar Kennestone Regional Medical Center

Mike Takacs, MD

University of Iowa

Sasha Tichter, MD

New York Presbyterian

Ed Ullman, MD

Beth Israel Deaconess Medical Center/Harvard Affiliated

Moshe Weizberg, MD

Staten Island University Hospital

The Accreditation Council for Continuing Medical Education requires that the planners and presenters of continuing medical education activities disclose financial relationships with commercial companies whose products or services are discussed in educational presentations.

The following planners, session leaders and panelists have no financial relationships with companies whose products are addressed in their planning or presentations.

James Ahn, MD, MHPE
University of Chicago

Saadia Akhtar, MD
Icahn School of Medicine
at Mount Sinai

Al'ai Alvarez, MD
Stanford University

Dhara Amin, MD
Cook County Hospital

Ambrosya Amlong
University of Michigan

Felix Ankel, MD
HealthPartners Institute/
Regions Hospital

Linette Archer, MD
The Ohio State University

Miguel Arribas, MD
Memorial Health System

Farhad Aziz, MD
The Ohio State University

Christine Babcock, MD
University of Chicago

Caitlin Bailey, MD
Highland Hospital

Kamna Balhara, MD
Johns Hopkins

Lori Barrett
HealthPartners Institute/
Regions Hospital

Michael Barrie, MD
The Ohio State University

Kelly Barringer, MD
HealthPartners Institute/
Regions Hospital

Kailey Bartrum
University of Michigan

Rebecca Bavolek, MD
UCLA Ronald Reagan/Olive View

Jennifer Beck-Esmay, MD
St. Luke's-Mount Sinai West

Michael Beeson, MD
Summa Health

Jeremy Berberian, MD
Christiana Care Health System

Rahul Bhat, MD
Georgetown/Medstar Washington
Hospital Center

Audrey Bickel, MD
Indiana University

Leslie Bilello, MD
Beth Israel Deaconess Medical
Center/Harvard Medical School

Nikki Binz, MD
University of North Carolina
Chapel Hill

Barbara Blok, MD
Denver Health

Sharon Bord, MD
Johns Hopkins

Richard Bounds, MD
University of Vermont Medical Center

Lauren Branditz, MD
The Ohio State University

Jeremy Branzetti, MD
NYU/Bellevue

E. Page Bridges, MD
Greenville Health System

Leah Bright, DO
Johns Hopkins

Alisha Brown, MD
University of Washington

Ryan Buckley, MD, MPH
Yale University

Jessica Burkhalter, BS
Medical College of Georgia

Bo Burns, DO
University of Oklahoma School of
Community Medicine

Simran Buttar, MD
Maimonides Medical Center

Yinka Cardoso
Henry Ford Hospital

David Carlberg, MD
Georgetown/Medstar Washington
Hospital Center

Guy Carmelli, MD
SUNY Downstate Kings County
Hospital Brooklyn

Wallace Carter, MD
New York-Presbyterian Hospital

Paul Casey, MD, FACEP
Rush Medical College

Carrie Chapman, BFA
Orlando Health

Douglas Char, MD
Washington University in St. Louis

Angela Chen, MD
Icahn School of Medicine
at Mount Sinai

Esther Chen, MD
University of California
San Francisco/Zuckerberg
San Francisco General Hospital

Alvin Chin, MD, MSC
McMaster University

Anne Chipman, MD, MS
University of Washington

Alex Chorley, MD, FRCPC
McMaster University

Yvonne Chow, MD, MSMS
Albany Medical Center

Arlene Chung, MD, MACM
Maimonides Medical Center

Richard Church, MD
University of Massachusetts

Melody Cikalo, C-TAGME
Beaumont Health

Michael Cole, MD
University of Michigan

Lauren Conlon, MD
University of Pennsylvania

Robert Cooney, MD, MSMEdEd
Geisinger Medical Center

Kyle Couperus, MD
Madigan Army Medical Center

Rachel Dahms, MD
HealthPartners Institute/
Regions Hospital

Nida Degesys, MD
Stanford University

William Deng, MD
University of Utah

Julie Dodson, MD
University of Oklahoma
School of Community Medicine

Michele Dorfsman, MD
University of Pittsburgh

Christopher Doty, MD
University of Kentucky

Caroline Dowers, MD
Henry Ford Hospital

Nicole Dubosh, MD
Beth Israel Deaconess Medical
Center/Harvard Medical School

Dana Dunleavy, PhD
Association of American Medical
Colleges (AAMC)

David Duong, MD, MS
Highland Hospital

Mary Ann Edens, MD
Lincoln Medical and Mental
Health Center

Daniel Egan, MD
Columbia University Vagelos College
of Physicians and Surgeons

Michael Ehmann, MD
Johns Hopkins

Geremiha Emerson, MD
Ohio State University

Michael Epter, DO, FAAEM
Maricopa Medical Center

Hilary Fairbrother, MD, MPH
McGovern Medical School UT Houston

Sarah Fallon, BA
University of Wisconsin, Madison

Timothy Fallon, MD
Maine Medical Center

Abra Fant, MD, MS
Northwestern University

Sarah Farris, MD
Greenville Health System

Jeremy Faust, MD, MS
Brigham and Women's/
Massachusetts General Hospital
Harvard Affiliated

Dana Ferguson, MBA
University of Louisville

Madonna Fernandez-Frackelton, MD
Harbor-UCLA Medical Center

Megan Fix, MD
University of Utah

Lindsay Flax, MD
UTSouthwestern Medical Center

Michele Floring
Maricopa Medical Center

Callan Fockele, MD, MS
University of Washington

Doug Franzen, MD
University of Washington

Jenna Fredette, MD
Christiana Care Health System

Gretchen Fuller, MD
University of California
San Francisco/Zuckerberg
San Francisco General Hospital

Hussein Gaafary, MD
Greenville Health System

Fiona Gallahue, MD
University of Washington

Moises Gallegos, MD, MPH
Baylor College of Medicine

Elizabeth Gignac, DO
Campbell University-Southeastern
Health

Jonathan Giordano, DO
McGovern Medical School UT Houston

Michael Gisondi, MD
Stanford University

Katja Goldflam, MD
Yale University

Margaret Goodrich, MD
UMass-Baystate Medical Center

David Gordon, MD
Duke University

Katarzyna Gore, MD
Rush Medical College

Michael Gottlieb, MD
Rush Medical College

Kristen Grabow Moore, MD, MEd
Emory University

Kristi Grall, MD, MHPE
HealthPartners Institute/
Regions Hospital

Tanner Gronowski, DO
US Acute Care Solutions

Omar Guzman, MD
Kaweah Delta

David Haidar, MD
University of Michigan

Matt Hall, MD
Brigham and Women's / Massachusetts General Hospital Harvard Affiliated

Chelsea Harrison
Northwestern University

Raquel Harrison, MD
Yale University

Danielle Hart, MD
Hennepin County Medical Center

Nicholas Hartman, MD, MPH
Wake Forest School of Medicine

Megan Healy, MD
Temple University

Tarlan Hedayati, MD
Cook County Hospital

Cullen Hegarty, MD
HealthPartners Institute/
Regions Hospital

Megan Henn, MD
Emory University

Lisa Herald
University of Michigan

Herbert Hern, MD
Highland Hospital

Dustin Hernandez, BS
Beaumont Health

Jamie Hess, MD
University of Wisconsin

SueLin Hilbert, MD, MPH
Washington University in St. Louis

Ann Hill
Orlando Health

Jeffery Hill, MD, MEd
University of Cincinnati

Katherine Hiller, MD, MPH
University of Arizona College of Medicine

Emily Hillman, MD
Truman Medical Center

Jaime Hope, MD
Beaumont Health

Laura Hopson, MD
University of Michigan

Joseph House, MD
University of Michigan

Rob Huang, MD
University of Michigan

Simon Huang, MSc
University of Saskatchewan

Oliver Hulland, MD
Yale University

Matthew Hysell, MD
Lakeland Health

Jonathan Ilgen, MD
University of Washington

Sophia Isoff, MPH
University of Chicago

Jacob Isserman, MD
Georgetown/Medstar Washington Hospital Center

Jennifer Jackson, MD, FACEP
University of Miami Miller School of Medicine

Raven-Olivia Jackson, MA
University of Michigan

Aarti Jain, MD
LAC+USC Medical Center

Melissa Janse, MD
Greenville Health System

Zach Jarou, MD
University of Chicago

Namita Jayaprakash, MB, Bch, BAO, MRCEM
Henry Ford Hospital

Lynn Jiang, MD
NYP Columbia-Cornell

David Jones, MD, MCR
Oregon Health and Science University

Jaime Jordan, MD
Harbor-UCLA Medical Center

Nikita Joshi, MD
Highland Hospital

Julianna Jung, MD
Johns Hopkins

Annahieta Kalantari, DO
Penn State Health at Hershey Medical Center

Bonnie Kaplan, MD
Denver Health

Kevin Keller, MS
Virginia Commonwealth University

Adam Kellogg, MD
UMass-Baystate Medical Center

Tara Kenny, MD
Oregon Health and Science University

Andrew Ketterer, MD, MA
Northwestern University

Jay Khadpe, MD
University of Florida, Jacksonville

Sorabh Khandelwal, MD
Ohio State University

Danya Khoujah, MBBS
University of Maryland

Michael Kiemeney, MD
Loma Linda University

Andrew King, MD
The Ohio State University

Matthew Klein, MD, MPH
Northwestern University

Timothy Koboldt, MD
University of Missouri

Damon Kuehl, MD
Virginia Tech Carilion

Evan Kuhl, MD
George Washington University

Paul Kukulski, MD
University of Chicago

Alicia Kurtz, MD
Mercy San Juan Medical Center

Jay Ladde, MD
Orlando Health

Michelle Lall, MD
Emory University

Robert Lam, MD
Memorial Hospital

Adaira Landry, MD
Brigham and Women's / Massachusetts General Hospital Harvard Affiliated

Chaiya Laoteppitaks, MD
Thomas Jefferson University

Charlotte Lawson, MD
Greenville Health System

Luan Lawson, MD, MAEd
East Carolina University

Kathleen Lee, MD
Penn Medicine

Charles Lei, MD
Vanderbilt University Medical Center

Denise Lesniak, MA
Metro Health Medical Center

Edward Lew, MD
Oregon Health and Science University

Larissa Lindquist, MEd
University of Pittsburgh

Simiao Li-Sauerwine, MD, MS
The Ohio State University

Andy Little, DO
Doctors Hospital

Jeff Liu, MD
Baylor College of Medicine

Shawn London, MD
University of Connecticut

Jeffrey Love, MD, MHPE
Georgetown/Medstar Washington Hospital Center

Elise Lovell, MD
Advocate Christ Medical Center

Lucienne Lutfy-Clayton, MD
UMass-Baystate Medical Center

Mira Mamtani, MD, MSEd
University of Pennsylvania

David Marcus, MD
Long Island Jewish Medical Center

Alison Marshall, MD
Temple University

Carolyn Martinez, MD
The Ohio State University

David Masneri, DO
Wake Forest School of Medicine

Dan Mayer, MD
Albany Medical College

Ryanne Mayersak, MD
Oregon Health & Science University

Kerry McCabe, MD
Boston Medical Center

Danielle McCarthy, MD, MS
Northwestern University

Douglas McGee, DO
Einstein Healthcare Network

Ryan McKillip, MD
Advocate Christ Medical Center

Kandice McLeod, MEd, C-TAGME
McGovern Medical School UT Houston

Mary McNatt
Orlando Health

Anne Messman, MD
Wayne State University

Susan Miller, MD
Orlando Health

Brian Milman, MD
Oklahoma University

Peter Moffett, MD
Virginia Commonwealth University

Joel Moll, MD
Virginia Commonwealth University

Derek Monette, MD
Brigham and Women's / Massachusetts General Hospital Harvard Affiliated

Tom Morrissey, MD
University of Florida, Jacksonville

Brendan Munzer, MD
University of Michigan

Tiffany Murano, MD
Rutgers New Jersey Medical School

Collyn Murray, MD
Washington University in St. Louis

Jose Nable, MD, MS, NRP
Georgetown/Medstar Washington Hospital Center

Nehal Naik, MD
George Washington University

Sreeja (Sree) Natesan, MD
Duke University

Mathew Nelson, DO
North Shore Long Island Jewish Health System

Nicole Nemore, MD
Wellstar Kennestone

Adam Nicholson, MD
University of Michigan/St. Joseph Mercy

Dhimitri Nikolla, DO
Allegheny Health Network

Patrick O'Brien, BS
University of Mississippi Medical Center

Mark Olaf, DO
Geisinger Medical Center

Adriana Olson, MD, MAEd
University of Chicago

James OShea, MBBS
Emory University

Benjamin Ostro, MD
Ohio State University

Leslie Oyama, MD
University of California San Diego

Glenn Paetow, MD, MACM
Hennepin County Medical Center

Dimitrios Papanagnou, MD
Thomas Jefferson University

Sara Paradise, MD
University of California, Irvine

Kendra Parekh, MD
Vanderbilt University
Medical Center

Joel Park, MD, FACEP
St. John's Residency Hospital

Viral Patel, MD
UMass Memorial

Rahul Patwari, MD
Rush Medical College

Alexis Pelletier-Bui, MD
Cooper Medical School of Rowan
University

Thomas Perera, MD
Northwell

William Peterson, MD
University of Michigan

Camiron Pfennig, MD, MHPE
Greenville Health System

Andrew Phillips, MD, MEd
University of North Carolina

Melanie Pigott, BA, C-TAGME
Medical University of South Carolina

Malford Pillow, MD, M.Ed.
Baylor College of Medicine

Mark Pittman, MD
Greenville Health System

Melissa Platt, MD
University of Louisville

Trevor Pour, MD
Mount Sinai Hospital

Cynthia Price, MD
University of Connecticut

Amy Ramsay, MD
Greenville Health System

Neha Raukar, MD, MS
Mayo Clinic

Linda Regan, MD
Johns Hopkins

Ronnie Ren, MD
UMass-Baystate Medical Center

Jennifer Repanshek, MD
Temple University

Zachary Repanshek, MD
Temple University

JanAlicia Ricker
Maine Medical Center

Jeff Riddell, MD
LAC+USC Medical Center

Adam Rieves, MD
Washington Univeristy in St. Louis

Magdalena Robak, MD
NYU/Bellevue

Sarah Ronan-Bentle, MD, MS
University of Cincinnati

Jason Rotoli, MD
University of Rochester

Christian Ruiz, MD
University of California, Irvine

Matthew Ryan, MD, PhD
University of Florida

Benjamin Schnapp, MD, MEd
University of Wisconsin, Madison

Caitlin Schrepel, MD
University of Washington

Kevin Scott, MD, MSEd
University of Pennsylvania

Nathaniel Scott, MD
Hennepin County Medical Center

Stefanie Sebok-Syer, PhD
Stanford University

Jamie Shandro, MD, MPH
University of Washington

Philip Shayne, MD
Emory University

Christina Shenvi, MD, PhD
University of North Carolina

Jan Shoenberger, MD
LAC+USC Medical Center

Jeffrey Siegelman, MD
Emory University

Manpreet Singh, MD
Harbor-UCLA Medical Center

Jennifer Singleton, MD
Beth Israel Deaconess Medical
Center/Harvard Medical School

Priyanka Sista, MD
Northwestern University

Janet Smereck, MD
Georgetown/Medstar Washington
Hospital Center

Liza Smith, MD
UMass-Baystate Medical Center

Teresa Smith, MD
SUNY Downstate Kings County
Hosp Brooklyn

Jaron Soulek, MD
University of Oklahoma

Jordan Spector, MD, MS
Boston Medical Center

Linda Spillane, MD
University of Rochester

Eric Steinberg, DO, FACEP
Mount Sinai Beth Israel

Edwatrd Stettner, MD
Wellstar Kennestone

Gowri Stevens, MD
McGovern Medical School UT
Houston

Megan Stobart-Gallagher, DO
Jefferson Health

Amita Sudhir, MD
University of Virginia

Christine Sullivan, MD
University of Missouri-Kansas City
School of Medicine

W. Gannon Sungar, DO
Denver Health

Loice Swisher, MD
Drexel University

Christina Tarleton, BS
Johns Hopkins

Todd Taylor, MD
Emory University

Josef Thundiyil, MD, MPH
Orlando Health

Aleksandr Tichter, MD
New York-Presbyterian Hospital

Brett Todd, MD
Beaumont Health

Shannon Toohey, MD
University of California, Irvine

Theresa Tran, MD, MBA
Baylor College of Medicine

Robert Turer, MD, MSE
University of Michigan/
St. Joseph Mercy

Edward Ullman, MD
Beth Israel Deaconess Medical
Center/Harvard Medical School

Ryan Van Nostrand, MD
Vanderbilt University Medical Center

Ryan Van Otten, MA
University of New Mexico

Taher Vohra, MD
Henry Ford Hospital

Jason Wagner, MD
Washington Univeristy
in St. Louis

Gina Waight, MD
Columbia University Medical Center

David Wald, DO
Temple University

Joshua Wallenstein, MD
Emory University

James Waymack, MD
Southern Illinois University

Moshe Weizberg, MD
Staten Island University Hospital

Katie Wells, MD, MPH
University of Vermont

Laura Welsh, MD
Boston Medical Center

Paul Logan Weygandt, MD, MPH
Johns Hopkins

Natasha Wheaton, MD
Northwestern University

Suzanne White, MD, MBA
City of Detroit

Warren Wiechmann, MD
University of California, Irvine

J. Scott Wieters, MD
Texas A&M

Kelly Williamson, MD
Advocate Christ Medical Center

George Willis, MD
University of Maryland

Scott Witt, MD
Greenville Health System

Brian Wood, MD
University of Southern California

Lainie Yarris, MD, MCR
Oregon Health & Science University

Rochelle Zarzar, MD
Hennepin County Medical Center

Fareen Zaver, MD
University of Calgary

Amy Zeidan, MD
University of Kentucky

Xiao Chi (Tony) Zhang, MD, MS
Thomas Jefferson University

These individuals have indicated that they have a relationship which, in the context of their involvement in the CME activity, could be perceived by some as a real or apparent conflict of interest (e.g., ownership of stock, grants, honoraria, or consulting fees), but these individuals do not consider that it will influence the CME activity.

Harrison Alter, MD
Alameda Medical Center Highland Hospital

Holly Caretta-Weyer, MD
Stanford University

Teresa Chan, MD, FRCPC, MHPE
McMaster University

Andrew Grock, MD
UCLA Ronald Reagan/Olive View

Maria Moreira, MD
Denver Health

Lisa Moreno-Walton, MD, MSCR
LSU New Orleans

Vicki Noble, MD
University Hospitals

Adam Rosh, MD
Rosh Review

Eric Shappell, MD, MHPE
Brigham and Women's / Massachusetts
General Hospital Harvard Affiliated

Award Recipients

Michael P. Wainscott Program Director

Michele Dorfsman, MD, *University of Pittsburgh*

CORD Resident Academic Achievement

Paul Jansen, MD, *Harvard Medical School*

CORD Faculty Teaching

Kristen Moore, MD, *Emory University School of Medicine*

CORD Program Coordinator

Jana Ricker, *Maine Medical Center Emergency Medicine*

Salvatore Silvestri Travel Scholarship

Rebecca Teague, MD, *University of Kentucky*

MERC AT CORD SCHOLAR AWARD

Marc Kanter, MD

Lincoln Medical & Mental Health Center

Andrew Grock, MD

UCLA Ronald Teagan/Olive View

Jorge Fernandez, MD

University of California, San Diego

Heather Lounsbury, MD

University of Virginia Health Sciences Center

ACEP/CORD TEACHING FELLOWSHIP 2019 SCHOLARSHIP RECIPIENT

Valerie Lou, MD

University of Rochester

Strong Memorial Hospital

MINI FELLOWSHIP IN WELLNESS LEADERSHIP 2018/2019 COURSE GRADUATES

Moira Carroll, MD

Icahn School of Medicine at Mount Sinai

Angela Chen, MD

Icahn School of Medicine at Mount Sinai

Molly Hartrich, MD

LAC+USC Emergency Medicine

Angelica McPartlin, MD

Harbor UCLA Medical Center

Samantha Reeder, MD

Maricopa Emergency Medicine

Caroline Schrodt, MD

Kaweah Delta Health Care

Katie Tausch, MD

Beaumont Emergency Medicine

Robert Turer, MD

University of Michigan

St. Joseph Mercy Hospital

CORD ACADEMY FOR SCHOLARSHIP IN EDUCATION

Academy Distinguished Educator in Educational Research

Jaime Jordan, MD

Academy Distinguished Educator in Educational Leadership

Michael Smith, MD

Academy Member in Teaching & Evaluation

Di Coneybeare, MD

Nevdeep Sekhon, MD

Academy Scholar in Education Leadership

Braden Hexom, MD

Christopher Sampson, MD

Academy Scholar in Education Research

Jeff Riddell, MD

Academy Scholar in Enduring Materials

Shannon Toohey, MD

Academy Scholar in Teaching & Evaluation

Andrew King, MD

James Webley, MD

CORD LONGEVITY AWARD

10 Years

Jose Ramirez, MD, Program Director,
Orlando Health

Josef Thundiyil, MD,

Program Director, *Orlando Health*

Aleksandr Tichter, MD,
Assistant Program Director,
New York Presbyterian Hospital

5 Years

Shannon Alwood, MD, Associate Program
Director, *LSU Health Science Center*

Terrell Caffery, MD, Program Director,
LSU Health Science Center

Christian Young, MD, Assistant Program
Director, *University of Nevada,
Las Vegas School of Medicine*

Ross Berkeley, MD, Program Director,
*University of Nevada,
Las Vegas School of Medicine*

Chad Branecki, MD, Associate
Residency Director, *University of
Nebraska Medical Center*

Patrick Lank, MD, MS, Assistant
Program Director,
Northwestern University

Payal Shah, MD, Associate Program
Director, *Beaumont Health*

EMARC LONGEVITY AWARD

30 Years

Rebecca Bluett, Program Coordinator,
WellSpan York Hospital

15 Years

Christiane Roeder-Sanchez,
Program Coordinator,
Harbor-UCLA Medical Center

10 Years

Melody Cikalo, Medical Education
Coordinator, *Beaumont Health*

5 Years

Michele Haynes, Program Manager,
University of Pennsylvania

Niki Hagan, Medical Education Coordinator,
University of Wisconsin

GRAB SOME SWAG!

VISIT THE CORD SWAG SHOP
ON THE 7TH FLOOR TO GET
YOUR GIFT AND SHOP SOME
GREAT ITEMS

MARCH 31 - APRIL 2

PROCEEDS OF SALES BENEFIT THE
CORD CARES FOUNDATION



CORD is 30!

We want you to

Celebrate!

with us!

**IN HONOR OF OUR BIG ANNIVERSARY,
WE'RE CHANGING THINGS UP!**

Instead of the standard conference lunch, you'll receive a \$30 Gift Card to explore and enjoy some of Seattle's best foodie neighborhoods during lunch on March 31–April 3, 2019.

After checking in and receiving your badge, pick up your **\$30 Visa Gift Card** at the Registration desk.*

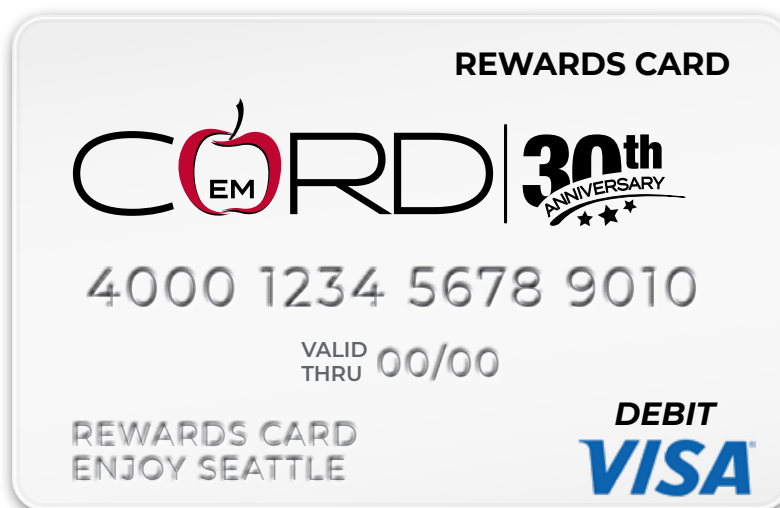

**Only one gift card per registrant. To qualify for the \$30 gift card, you must be registered for the entire conference (March 31–April 3, 2019). You must present your official 2019 CORD Academic Assembly Conference badge to receive your card. No other form of ID will be accepted. You cannot pickup a gift card for anyone other than yourself. This \$30 gift card is to supplement lunch for March 31 & April 2, 2019. CORD will not be providing lunch March 31–April 3.*

Day One Sunday, March 31

	New Programs New Leaders	Best Practices	Navigating the Academic Waters (NAW)	CDEM	EMARC	iMedEd	Resident	Chief Resident	MERC Day 2	CPC
7:00-8:00				Breakfast — Regency Ballroom B, 7th fl						
8:00-8:30				WELCOME FROM PROGRAM CHAIRS, TRACK CHAIRS AND COORD PRESIDENT — Regency Ballroom A, 7th fl						
8:30-8:45				BREAK						
8:45-9:15										
9:15-9:20										
9:20-9:25										
9:25-9:50										
9:50-9:55										
9:55-10:00										
10:00-10:15										
10:15-10:25										
10:25-10:45										
10:45-10:50										
10:50-11:00										
11:00-11:10										
11:10-11:15										
11:15-12:00										

<p>Positive Feedback Made Viral (Kathleen Lee; Amy Waldner, Lauren Conton) Columbia Ballroom A, 3rd fl</p> <p>330: Novel Evaluations (Jeremy Branzetti) PANEL: Phillip Shayne, Wallace Carter, Christine Sullivan, Suzanne White) Columbia Ballroom C, 3rd fl</p> <p>Inside the RRC (Edward Stettner; PANEL: Phillip Shayne, Wallace Carter, Christine Sullivan, Suzanne White) Columbia Ballroom C, 3rd fl</p> <p>How to Conference (Collyn Murray, Jason Wagner) Columbia Ballroom D, 3rd fl</p> <p>Coaching Students to Succeed During Mid-Clerkship Feedback (Jose Nable, Janet Smereck, Rahul Bhat, Jacob Isserman) Elwha Ballroom A, 5th fl</p> <p>EMARC Welcome & Networking (Jana Ricker, Melanie Pigott) Elwha Ballroom B, 5th fl</p> <p>So You Want to be an Entrepreneur? (Adam Rosh) Quinnault Ballroom, 5th fl</p> <p>Fellowship or Bust (Holly Carretta-Wyer, Paul Kukulski; PANEL: Lindsay Flax; Adaira Landry; Kendra Parekh) #702 Clearwater, 7th fl</p> <p>Resident Finances 101 (Eric Shappel; Ryan McKilip) #702 Clearwater, 7th fl</p> <p>Attend Resident or Faculty Tracks</p>	<p>Spotting a Resident in Distress (Michele Dorfman; Larissa Lindquist) Elwha Ballroom B, 5th fl</p> <p>Be the Captain of Your Mentor-Ship: How to Enhance the Mentee Part of the Relationship (Megan Fix) Elwha Ballroom A, 5th fl</p> <p>460 MENTORSHIP (Edward Ullman) Mentorship After Residency (Andrew Kettere) "May I Pick Your Brain?" (Leah Bright, Linda Regan) "I'm So Confused!" (James Ahn, Edward Ullman) Mentoring for Millennials: A Modern Approach (Caroline Dowers; Namita Jayaprakash) Columbia Ballroom D, 3rd fl</p> <p>Competency-Based Handovers to Graduate Medical Education: A Framework to Bridge the Transition (Holly Carretta-Wyer) Columbia Ballroom A, 3rd fl</p> <p>Mind the Gap: A Professional Development Session for Women in Emergency Medicine (Abra Fant; PANEL: Allison Marshall, Danielle McCarthy, Priyanka Sista) Columbia Ballroom A, 3rd fl</p>	<p>Steering the Ship Without Driving...Chief Residents and Program Directors (Thomas Perera, Matthew Nelson) Columbia Ballroom D, 3rd fl</p> <p>460 MENTORSHIP (Edward Ullman) Mentorship After Residency (Andrew Kettere) "May I Pick Your Brain?" (Leah Bright, Linda Regan) "I'm So Confused!" (James Ahn, Edward Ullman) Mentoring for Millennials: A Modern Approach (Caroline Dowers; Namita Jayaprakash) Columbia Ballroom D, 3rd fl</p> <p>Competency-Based Handovers to Graduate Medical Education: A Framework to Bridge the Transition (Holly Carretta-Wyer) Columbia Ballroom A, 3rd fl</p> <p>Mind the Gap: A Professional Development Session for Women in Emergency Medicine (Abra Fant; PANEL: Allison Marshall, Danielle McCarthy, Priyanka Sista) Columbia Ballroom A, 3rd fl</p>	<p>How to Build a Culture of Innovation in Your ED (Paul Casey) Quinnault Ballroom, 5th fl</p> <p>Work Deep, Get Productive! 10 Tips for Ramping up Your Research (Michael Gottlieb) #702 Clearwater, 7th fl</p> <p>What's Up With What's App? Managing Residency Dynamics in the Era of Group Chats (Robert Huang, Adam Nicholson) Quinnault Ballroom, 5th fl</p> <p>Talk Techy To Me: Panel Discussion (Melanie Pigott, Jessica Burkhalter, Patrick O'Brien) Elwha Ballroom B, 5th fl</p> <p>NCAT EM: Two Years of Use (Kathy Hiller; PANEL: Jules Jung, Luan Lawson, Doug Franzen) Elwha Ballroom A, 5th fl</p>	<p>EMARC — Where Do We Go From Here? OUR Future is NOW — Are YOU Ready?</p> <p>Validity Evidence in Emergency Medicine Assessment and Evaluation Tools (Kathy Hiller; PANEL: David Wald; Damon Kuehl;</p> <p>Lessons Learned in Medical Education Research (Michael Gottlieb; PANEL: Jamie Jordan, Nick Hartmann, Jeff Love, Laura Hopson) (Combined BP & NAW)</p>	<p>Riding The Waves: Tips to Flourishing in Residency, Both Personally and Professionally (Farhad Aziz; Andrew King;</p> <p>We Survived! Stories and Lessons from Former Chief Residents (Gina Waight; PANEL: Raquel Harrison; Brian Wood; Joel Park) Regency Ballroom A, 7th fl</p>	<p>MERC 3 — Introduction to Qualitative Data Collection Methods (Sheila Chauvin) 701 Clallum, 7th fl</p>
--	---	---	---	--	--	---

Day Two 🍌 Monday, April 1

	NPL	Best Practices	Navigating the Academic Waters (NAW)	CDEM	EMARC	iMedEd	Resident	Special	CPC
7:00-8:00	Breakfast — Regency Ballroom B, 7th fl								
8:00-8:30	<p>The Basics of Starting a New Residency Program (Moshe Weizberg; Fiona Gallahue) Columbia Ballroom C, 3rd fl</p>	<p>CCC Squared: Creating a Constructive and Comprehensive CCC (Michael Ehmann; Leah Bright; Logan Wegandt; Christina Tarleton) Combined BP & EMARC **EMARC To lead confirmations** Columbia Ballroom A, 3rd fl</p>	<p>Imposter Syndrome: Getting Out of Your Own Way (Fareen Zaver; Natasha Wheaton; PANEL: Jaime Hope, Arlene Chung, Rebecca Bavolek) Columbia Ballroom D, 3rd fl</p>	<p>Giving Real-Time Feedback to Students: Coaching Your Students to Their Personal Best (Jay Laddie, Josef Thundiyil) Elwha Ballroom A, 5th fl</p>	<p>CCC Squared: Creating a Constructive and Comprehensive CCC (Michael Ehmann; Leah Bright; Logan Wegandt; Christina Tarleton,) Combined BP & EMARC **EMARC To lead confirmations** Columbia Ballroom A, 3rd fl</p>	<p>Maintaining Engagement on Social Media Platforms (Derek Monette; Nikita Joshi; Matt Klein) Quinault Ballroom, 5th fl</p>	<p>Let's Be Real, You Need a Job Now (Edward Lew; Tara Kenny) #702 Clearwater, 7th fl</p>	<p>How to Get Involved with CORD (Chris Doly) Regency Ballroom A, 7th fl</p>	
8:30-9:00	<p>Teaching Culturally Responsive Care (Gleen Paetow; Aarti Jain; Nate Scott; PANEL: Rochelle Zarzar) Columbia Ballroom C, 3rd fl</p>	<p>Education Journal Club (Esther Chen, David Duong, David Gordon) Combined BP & CDEM **CDEM to lead confirmations** Columbia Ballroom A, 3rd fl</p>	<p>Going Public: Getting Your Message Out to the Masses (Jeremy Faust) Columbia Ballroom D, 3rd fl</p>	<p>Education Journal Club (Esther Chen, David Duong, David Gordon) Combined BP & CDEM **CDEM to lead confirmations** Columbia Ballroom A, 3rd fl</p>	<p>EMARC Business Meeting Elwha Ballroom B, 5th fl</p>	<p>Needle in a Haystack: How to Find and Evaluate High Quality FOAM (Andrew Grock, Fareen Zaver, Michael Gottlieb, Teresa Chan) Quinault Ballroom, 5th fl</p>	<p>Remediation Consult Service #601 Hoh, 6th fl</p>	<p>CPC DAY 2 Room 1 #603 Skagit Room 2 #604 Skykomish Room 3 #605 Snohomish Room 4 #606 Twisp Room 5 #607 Wishkah Room 6 #608 Wynoochee 6th fl</p>	
9:00-9:10	BREAK								
9:10-9:20	<p>Expanding Your Reach - Virtual Mentorship (Maria Moreira; Saadia Akhtar) Columbia Ballroom C, 3rd fl</p>	<p>Torpedo's in the Water: Getting Sunk By a SLOE-pedo (Adam Kellog, Tom Morrissey, Jamie Shandro, Emily Hillman) Combined BP & CDEM **CDEM to lead confirmations** Columbia Ballroom A, 3rd fl</p>	<p>Affiliate Sites: Careers in Education Outside the House of Medicine (Caitlin Bailey) Columbia Ballroom D, 3rd fl</p>	<p>Torpedo's in the Water: Getting Sunk By a SLOE-pedo (Adam Kellog, Tom Morrissey, Jamie Shandro, Emily Hillman) Combined BP & CDEM **CDEM to lead confirmations** Columbia Ballroom A, 3rd fl</p>	<p>EMARC Track Planning Elwha Ballroom B, 5th fl</p>	<p>BREAK</p>	<p>How to Succeed Your First Year Out (Christine Shenvi, Nikki Binz) #702 Clearwater, 7th fl</p>		
9:20-9:40	<p>Our Collective Experience: Pearls and Pitfalls of Foundations Implementation (Kristen Grabow, Jeremy Berberian, Natasha Wheaton) Columbia Ballroom C, 3rd fl</p>	<p>When Program Leadership and Parenting Collide (SueLin Hilbert) Columbia Ballroom D, 3rd fl</p>	<p>Coordinator Wellness (Sophia Isoff) Elwha Ballroom B, 5th fl</p>	<p>Developing and Refining Your Online Presence: A Hands-On Workshop (Rob Cooney, Michael Gottlieb, Fareen Zaver, Teresa Chan) Quinault Ballroom, 5th fl</p>	<p>Taking Control of Your Social Media Profile (Rob Cooney) Quinault Ballroom, 5th fl</p>	<p>BREAK</p>	<p>Social Media Snafus: Could You be Next? (Sara Paradise; Christian Ruiz) #702 Clearwater, 7th fl</p>		
9:40-9:45	BREAK								
9:45-10:00	BREAK								
10:00-10:15	BREAK								
10:15-10:20	BREAK								

Day Three 🍎 Tuesday, April 2

	NPL	Best Practices	Navigating the Academic Waters (NAW)	CDEM	EMARC New Coordinators	EMARC Clerkship Coordinators	EMARC Seasoned Coordinators	iMedEd
7:00–8:00	Breakfast — Regency Ballroom B, 7th fl							
8:00–8:25	<p>Due Process of Physicians and Residents Following Major Program Disruption (Douglas Char, Mary Ann Edens; Linette Archer; Shawn London; Melissa Platt) <i>Columbia Ballroom C, 3rd fl</i></p>	<p>Social Emergency Medicine: Creating a Curriculum for Physician Advocates and Holistic Providers in the 21st century (Fiona Gallahue, Annie Chipman, Caitlan Fockele; PANEL: Harrison Alter) <i>Columbia Ballroom A, 3rd fl</i></p> <p>Teaching Clinical Efficiency: Tapping into a Learner's Full Potential! (Guy Carmeli, Mark Silverberg) <i>Columbia Ballroom A, 3rd fl</i></p>	<p>Getting Started in Medical Education Research (Jaime Jordan) <i>Columbia Ballroom D, 3rd fl</i></p>	<p>Evidence Based Recommendation for the Visiting Student Application Population (Xiao Chi Zhang, David Gordon; Doug Franzen, Joshua Wallenstein; PANEL: Ronnie Ren, Lucienne Lufty-Clayton) <i>Elwha Ballroom A, 5th fl</i></p>	<p>Program Coordinator Resources and How To Find Them (Melody Cikalo; Dustin Hernandez) <i>#601 Hoh, 6th fl</i></p>	<p>VSAS Updates and Tricks (Jessica Burkhalter) <i>#602 Nooksack, 6th fl</i></p>	<p>Adulting of the Millennial Intern (Kristy Grall; PANEL: Lori Barrett, Kelly Barringer, Rachel Dahms) <i>Elwha Ballroom B, 5th fl</i></p>	<p>Infographics Didactic and Workshop (Alvin Chin, Teresa Chan; PANELIST: Simon Huang) <i>Quinault Ballroom, 5th fl</i></p>
8:25–8:50	BREAK							
8:50–9:00	BREAK							
9:00–9:30	BREAK							
9:30–10:00	<p>CORD Business Meeting Combined Session, BP, NPL, EMARC <i>Columbia Ballroom A, 3rd fl</i></p>	<p>Meeting of the Minds: The Power of Creating a Mastermind Group (Sreeja Natesan; Charlotte Lawson; Glenn Paetow; Michael Gottlieb; PANEL: Gretchen Fuller; Fareen Zaver) <i>Columbia Ballroom D, 3rd fl</i></p>	<p>How to Find the Best Away Rotators (and How to Get Your Students Away Rotations) (Hillary Fairbrother, Jonathan Giordano, Gowri Stevens) <i>Elwha Ballroom A, 5th fl</i></p>	<p>How to Find the Best Away Rotators (and How to Get Your Students Away Rotations) (Hillary Fairbrother, Jonathan Giordano, Gowri Stevens) <i>Elwha Ballroom A, 5th fl</i></p>	<p>Making a Path for the Most Vulnerable: Best Practices in Advising the "At Risk" Applicant (Lucienne Lufty-Clayton, Kendra Parekh; Adam Kellogg; Tom Morrissey; PANEL: Jamie Shandro; Mark Olaf; David Gordon) <i>Elwha Ballroom A, 5th fl</i></p>	<p>CORD Business Meeting Combined Session, BP, NPL, EMARC <i>Columbia Ballroom A, 3rd fl</i></p>	<p>More Than Meets the Eye: Virtual Reality in Medical Education (Michael Barrie, Tim Koboldt, Warren Wiechman) <i>Quinault Ballroom, 5th fl</i></p>	<p>Learning By Design: Running Your Own Design Thining Workshop (Teresa Chan, Michael Gottlieb, Rob Cooney, Alex Chorney) <i>Quinault Ballroom, 5th fl</i></p>
10:00–10:30	BREAK							
10:30–10:45	BREAK							
10:45–11:15	<p>So You Want to Play in the Big Leagues: Transcribing the Unwritten Rules of Academic Politics for Young Attendings (Matt Hall, Nicole Dubosh) <i>Columbia Ballroom D, 3rd fl</i></p>	<p>Leadership Lessons from a Year with the Philadelphia Eagles (Yvonne Chow) <i>Columbia Ballroom D, 3rd fl</i></p>	<p>Role and Impact of Gender and Ethnicity in Mentoring (Danya Khoujah, Terlan Hedayati, Dhara Amin) <i>Columbia Ballroom D, 3rd fl</i></p>	<p>The SVI and How to Have Your Students Ace It (Hillary Fairbrother, Jonathan Giordano) <i>Elwha Ballroom A, 5th fl</i></p>	<p>345: A Guide to Mentoring URM, LGBT, and Women EM Applicants (Sharon Bord, Kendra Parekh) Mentoring the Underrepresented When You Do Not Share the Background (Ronnie Ren, Adam Kellogg, Jaime Hess) Tackle the Challenges in EM Facing URM and/or LGBT Trainees (Joel Moll, Nehal Naik, Nicole Nemore, Audrey Bicke) Gender Disparities in Emergency Medicine-bound Students (Caitlin Bailey)</p>	<p>RRC Update and Q&A Combined Session, BP, NPL, EMARC <i>Columbia Ballroom A, 3rd fl</i></p>	<p>RRC Update and Q&A Combined Session, BP, NPL, EMARC <i>Columbia Ballroom A, 3rd fl</i></p>	<p>Top i-Med Papers (Jeff Riddell, Teresa Chan, Michael Gottlieb, Jon Ilgen) <i>Quinault Ballroom, 5th fl</i></p>
11:15–11:30	BREAK							
11:30–12:00	BREAK							
11:30–12:00	BREAK							

12:00-12:30	12:30-1:30	1:30-2:00	2:00-2:05	2:05-2:35	2:35-2:45	2:45-3:15	3:15-3:30	3:30-3:35	3:35-3:50	3:50-4:10	4:10-4:15	5:00-6:00	6:00-8:00
<p>Neighborhood Lunch Use your gift card to explore the local neighborhood Present your badge at the registration desk to receive yours</p>		<p>Coaching Residents: Competencies and Insights From Professional Coaches (Jeremy Branzetti, Magdalena Robak, Natasha Wheaton, Melissa Platt, Dana Ferguson) Combined BP & NPL **NPL to lead confirmations*** Columbia Ballroom A, 3rd fl</p>		<p>SLOE 101: An Introductory Course (Cullen Hegarty, Tom Morrissey; PANEL: Sarah Roman-Bentle, Matt Ryan, Damon Kuehl, Kathy Hiller, Chrissy Babcock) Elwha Ballroom A, 5th fl</p>		<p>EMARC Coordinator Lunch — Hosted by EMRA Elwha Ballroom B, 5th fl *Pre-Registration Required</p>		<p>Quinault Ballroom, 5th fl</p>					
<p>Coaching Residents: Competencies and Insights From Professional Coaches (Jeremy Branzetti, Magdalena Robak, Natasha Wheaton, Melissa Platt, Dana Ferguson) Combined BP & NPL **NPL to lead confirmations*** Columbia Ballroom A, 3rd fl</p>		<p>Anchors Up! Avoiding Cognitive Bias: Teaching Strategies for the Clinician Educator (Leslie Bieleo, Nicole Dubosh, Jennifer Singleton) Columbia Ballroom D, 3rd fl</p>		<p>SLOE 101: An Introductory Course (Cullen Hegarty, Tom Morrissey; PANEL: Sarah Roman-Bentle, Matt Ryan, Damon Kuehl, Kathy Hiller, Chrissy Babcock) Elwha Ballroom A, 5th fl</p>		<p>EMARC Coordinator Lunch — Hosted by EMRA Elwha Ballroom B, 5th fl *Pre-Registration Required</p>		<p>Quinault Ballroom, 5th fl</p>					
<p>Innovations in Remediation and Mentoring (Teresa Smith, Guy Carmeli) Columbia Ballroom C, 3rd fl</p>		<p>Turning Your Passions into Scholarship (Tim Koboldt, Michael Barrie) Columbia Ballroom D, 3rd fl</p>		<p>Note Writing for Medical students: How the CMS Changes Impact their Notes (Joseph House, Kathy Hiller, Miguel Arribas) Elwha Ballroom A, 5th fl</p>		<p>Change Management for the Program Coordinator (Maria Moreira, Saadia Akhtar) #601 Hoh, 6th fl</p>		<p>A Year in the Life of a New Coordinator (Yinka Cardoso, Taher Vohra) #601 Hoh, 6th fl</p>					
<p>Reaching the Reluctant — Coaching Faculty to Make On-Shift Teaching Work (Jamie Shandro, Laura Welsh) Columbia Ballroom A, 3rd fl</p>		<p>Medical Student Documentation Feedback (Mark Olati) Elwha Ballroom A, 5th fl</p>		<p>Documenting Your Program (Saadia Akhtar, Maria Moreira) #601 Hoh, 6th fl</p>		<p>The Examined Interview Day (Benjamin Schnapp, Sarah Fallon) #602 Nooksack, 6th fl</p>		<p>Being a Residency Parent (Carmie Chapman) Elwha Ballroom B, 5th fl</p>					
<p>ESCAPED- Explore Synergy, Communication, and Partnership in Emergency Department (Cami Plennig) Columbia Ballroom C, 3rd fl</p>		<p>“iTeach” — A Method for Teaching On Shift (David Masner) Columbia Ballroom D, 3rd fl</p>		<p>CDEM Town Hall (Luan Lawson; Kathy Hiller) Elwha Ballroom A, 5th fl</p>		<p>Facilitating Feedback: Increasing Compliance With End of Shift Feedback (Michael Gootlieb, Sreeja Natesan) #602 Nooksack, 6th fl</p>		<p>So You Want to Record a Podcast? (Jeff Riddell, Andy Little) LIMIT 75 Quinault Ballroom, 5th fl #502 Cowlitz, 5th fl</p>					
<p>You’re Leaving??? (Kerry McCabe, Jordan Spector) Columbia Ballroom C, 3rd fl</p>		<p>Combining Powers: A Collaborative Conference Strategy (Ryenne Mayersak, David Jones) Columbia Ballroom D, 3rd fl</p>		<p>Teaching Diagnostic (Cognitive Error) to Medical Students and Residents (Dan Meyer, Sorabh Khandelwal, Michael A. Cole, Brendan W. Munzer) Elwha Ballroom A, 5th fl</p>		<p>Table Talks for the New PC: 360 & Semi-annual Evals, Didactics & ERAS Tips (Amborsya Amlong; PANEL: Kaitley Bartrum; Raven-Olivia Jackson; Lisa Herald) #601 Hoh, 6th fl</p>		<p>So You Want to Write a Blog? (Jay Khadpe, Manny Singh, Jeffrey Hill, David Marcus) LIMIT 75 Quinault Ballroom, 5th fl #502 Cowlitz, 5th fl</p>					
<p>NPL Survival Stories (David Duong, Jordan Spector) Columbia Ballroom C, 3rd fl</p>		<p>Teaching to Talk so You can Talk to Teach (Jason Wagner, Ed Ulman) Columbia Ballroom D, 3rd fl</p>		<p>345: Curricular Innovations in UME (Kendra Parekh; Sharon Bord)</p>		<p>Join Another EMARC Session (Denise Lesniak) Elwha Ballroom B, 5th fl</p>		<p>So You Want to Enhance Your Slides? (Annaheta Kalantari, Rahul Patwari, Tyson Pillow) LIMIT 75 Quinault Ballroom, 5th fl #502 Cowlitz, 5th fl</p>					
<p>Resilience 545: (Leslie Oyama, Jeremy Branzetti) Turn that Frown Upside Down (Joel Moll, Kevin Keller)</p>		<p>Residency Retreat Redesign to Build Resiliency (Al’ai Alvarez) (Robert Lamm)</p>		<p>Incorporating Community Service into EM Rotations: A Curriculum in Social EM (Omar Guzman) (Megan Henn) Level Up Your Lectures (J. Scott Wieters) Elwha Ballroom A, 5th fl</p>		<p>Let’s Acronym Together (Denise Lesniak) Elwha Ballroom B, 5th fl</p>		<p>So You Want to Write a Blog? (Jay Khadpe, Manny Singh, Jeffrey Hill, David Marcus) LIMIT 75 Quinault Ballroom, 5th fl #502 Cowlitz, 5th fl</p>					
<p>Point of Care Resiliency (Robert Lamm)</p>		<p>Resident Talent Showcase (Katja Goldflam, Leah Bright)</p>		<p>Flipping the Switch — Moving from Burnout to Resilience (Kelly Williamson, Elise Love!!) Columbia Ballroom A, 3rd fl</p>		<p>Let’s Acronym Together (Denise Lesniak) Elwha Ballroom B, 5th fl</p>		<p>So You Want to Write a Blog? (Jay Khadpe, Manny Singh, Jeffrey Hill, David Marcus) LIMIT 75 Quinault Ballroom, 5th fl #502 Cowlitz, 5th fl</p>					
<p>CORD Closing Reception — offsite — Museum of Pop Culture; must have your badge to gain entrance</p>													

Day Four Wednesday, April 3

	Best Practices	Navigating the Academic Waters
7:00–8:00	Breakfast — <i>Columbia Ballroom BC, 3rd fl</i>	
8:00–9:00	Best of the Best (Bo Burns; Jeffrey Siegelman) <i>Columbia Ballroom A, 3rd fl</i>	
9:00–10:15	PD/CD Survival Stories (Sharon Bord; Madonna Fernandez; Tiffany Murano) <i>Columbia Ballroom A, 3rd fl</i>	
10:15–10:30	Break	
10:30–10:50	Developing a Curricular Toolkit for Broad Programmatic Dissemination (Holly Caretta-Wyer; Sasha Tichter) <i>Columbia Ballroom A, 3rd fl</i>	Make It Stick in Emergency Medicine (Jordan Spector) <i>Columbia Ballroom D, 3rd fl</i>
10:50–11:10	Coaching and Mentorship 220: (Leslie Oyama; Jeremy Branzetti)	It's Like Herding Cats: Tips for Collaboration for Research Projects With Other Specialties (Leah Bright; Katja Goldflam; Kamna Balhara) <i>Columbia Ballroom D, 3rd fl</i>
11:10–11:30	Coaching Faculty on New Teaching Processes in the ED: Implementing Recommendations from a Resident Experience RPM (Barbara Block; Bonnie Kaplan)	Adults Are Just Big Kids: Learning Theories and Practical Ways to Improve Your Teaching (Andrew Phillips; Tyson Pillow) <i>Columbia Ballroom D, 3rd fl</i>
11:30–12:00	Creating a Productivity and Lateral Mentoring (PALM) Small Group (Page Bridges; Sarah Farris; Mark Pittman) <i>Columbia Ballroom A, 3rd fl</i>	
	Curricular Ideas 330 (Leslie Oyama; Jeremy Branzetti)	
	A New Model for Morbidity and Mortality Conference: The Prospective Approach (Andrew King; Benjamin Ostro)	
	What is that Lurking in the Shadows - a Latent Risk Threat? Using Simulation as a Framework for Quality Improvement! (Rochelle Zarzar; Glenn Paetow)	
	Evidence-Based Teaching: Applying Adult Learning Theory to Improve your Presentation (Gannon Sungar) <i>Columbia Ballroom A, 3rd fl</i>	Technology Enhanced Bedside Teaching — Practical Tips to Improve Teaching on Your Next Shift (Tyson Pillow) <i>Columbia Ballroom D, 3rd fl</i>

Leadership and Advancement 330
(Leslie Oyama; Jeremy Branzetti)

Residents as Leaders — Allowing Senior Residents to Get Maximally Involved
(Guy Carmelli)

Leader as Servant — Applying Servant Leadership in the ED
(Teresa Tran)

Sitting at the Head of the Table
(Neha Raukar)
Columbia Ballroom A, 3rd fl

12:00 –
12:30

Lunch on your own and END

12:30 –
1:30



Better TOGETHER

CORD Academic Assembly
SEATTLE, WASHINGTON

**NAVIGATE THE
CONFERENCE
WITH EASE**

**DOWNLOAD THE
CORD ACADEMIC
ASSEMBLY APP**

**AVAILABLE IN
GOOGLE PLAY &
APPLE APP STORE**



FLOOR PLANS



Level 6

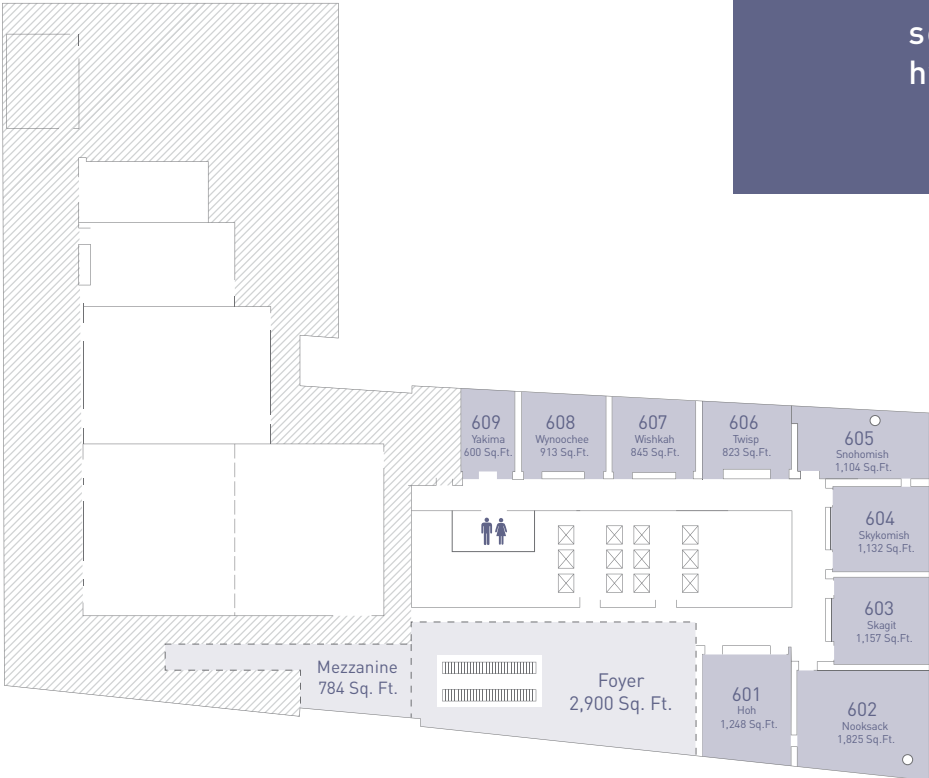

Level 7





Better
TOGETHER

CORD Academic Assembly
SEATTLE, WASHINGTON

Childcare & Mother's Room

Childcare and a dedicated mother's room
to care for yourself and your little one
are located on the 7th floor.

Childcare presented by



COUNCIL OF RESIDENCY DIRECTORS IN EMERGENCY MEDICINE



ZEN DEN

Available from
Sunrise to
Sundown daily.



*Thank you for respecting silence in this place
of prayer, meditation, reflection and relaxation.*



Committee Meetings

MARCH 31

7:00 – 8:00 AM

Academy for Scholarship	#307 Methow
APD Community of Practice	#501 Chiwawa
Bylaws Committee	#609 Yakima
Dual Training Community of Practice	#602 Nooksack
Four Program Community of Practice	#509 Tolt

12:30 – 1:30 PM

Education Committee	#609 Yakima
Remediation Committee	#307 Methow
Resilience Committee	#509 Tolt
Social Media & Informatics Committee	#602 Nooksack
Transitions of Care Task Force	#501 Chiwawa

APRIL 1

7:00 – 8:00 AM

Application Process Improvement Task Force	#307 Methow
Governance Committee	#501 Chiwawa
Medical Education Fellowships Community of Practice	#602 Nooksack
Simulation Community of Practice	#609 Yakima

APRIL 2

7:00 – 8:00 AM

Advising Students Committee in EM (ASC-EM)	#607 Wishkah
Best Practices Track Planning Committee	#701 Clallum
iMedEd Track Planning	Mr. West Cafe Bar
Physician Due Process Task Force	#501 Chiwawa
Prevention & Mitigation of Workplace Violence Working Group	#608 Wynoochee

12:30 – 1:30 PM

County Programs Community of Practice	#608 Wynoochee
IDEAS! Committee	#607 Wishkah
Navigating the Academic Waters Track Planning	Columbia Ballroom D
New Programs & Leaders Track Planning	#501 Chiwawa

APRIL 3

7:00 – 8:00 AM

CORD Academy Education Research and Scholarship Pillar	#602 Nooksack
Osteopathic Community of Practice	#608 Wynoochee

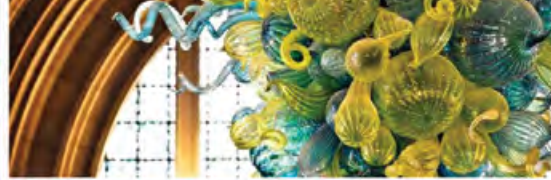

Afternoon Off — Tours!

CORD Chihuly Tour (\$57)

2:00 – 4:00 PM *Limited to 30 attendees*

The guided tour will take you through the inspiration and influences that inform the career of artist Dale Chihuly, the Exhibition includes eight Galleries, the centerpiece Glasshouse and a lush Garden. The centerpiece of Chihuly Garden and Glass is the Glasshouse. A 40-foot tall, glass and steel structure covering 4,500 square feet of light-filled space, the Glasshouse is the result of Chihuly's lifelong appreciation for conservatories. The installation in the Glasshouse is an expansive 100-foot long sculpture in a color palette of reds, oranges, yellows and amber. Made of many individual elements, it is one of Chihuly's largest suspended sculptures. The perception of the artwork varies greatly with natural light and as the day fades into night.

CORD Pike Place Market Tour (\$57)

2:00 – 4:00 PM *Limited to 16 attendees*

This Eat Seattle chef food tour takes you on a journey through the best artisanal vendors in the famous Pike Place Market. Get the inside scoop on where chefs shop and locals hang out. What makes our tour unique? Chef's Tour: Though many tourists are attracted to the famous Pike Place Market every year, local chefs also selectively choose their seasonal produce and proteins daily from the market. This tour gives us a taste of the vendors that supply the best chefs in town with their organic produce and sustainable seafood. Tours are run by chefs who contribute a culinary perspective, telling the story of the Northwest through its food.

CORD Chef Guided Chocolate & Coffee Tour (\$68)

2:00 – 4:00 PM *Limited to 16 attendees*

This downtown walking tour takes your palate on a discovery of the most delicious chocolate and coffee in Seattle. Visit a bean-to-bar factory, savor ganache confections made with real ingredients and learn about the iconic Fran's salted caramel. Explore the coffee scene both new and learn about roasters who have shaped the industry. Get tips and tricks from your chef guide on how to improve your cup of Joe in the morning or make your own sweets at home. All highlighted companies are local Seattle businesses with a story that stems from a passion to source soundly and make decadent sweets or beverages. This is a unique way to explore Seattle, its small businesses and savor our local delicacies.

cordem.org/Tours



Dinners

March 31

CORTINA

621 Union St., Seattle, WA 98101

6:00 PM – 8 seats available

An 8 minute walk or 5 minute car ride – indulge in some one Seattle's best Italian food located in Two Union Square, Cortina is at the base of one of Seattle's most prominent commercial towers in downtown.

CUTTER'S CRABHOUSE

2001 Western Ave., Seattle, WA 98121

6:00 PM – 10 seats available

Just one block from the water, Cutters is sure to be a grand old time with what Seattle is known for, Seafood! Cutters Crabhouse seafood restaurant is located in downtown Seattle near the historic Pike Place Market. They have a quarter-century long tradition of serving the freshest Northwest seafood including crab, salmon, clams, shrimp, halibut and more. Enjoy spectacular panoramic views of the Elliot Bay waterfront while dining on the "perfect taste" of Seattle.

WILD GINGER DOWNTOWN SEATTLE

2202B 8th Ave., Seattle, WA 98121; 206.707.0396

6:00 PM – 8 seats available

In the heart of Pike Place Market, get inspired by how Wild Ginger creates traditional Asian cuisine reinvented for modern taste, served with intention and gratitude, each and every time.

NO ANCHOR

2505 2nd Avenue, Suite 105, Seattle, WA 98121

5:45 PM – 6 seats Available

A 1-mile walk or 10 minute car ride, burn some calories before you enjoy some craft beer. No anchor is a world class beer bar and pacific northwest restaurant in the historic belltown neighborhood of seattle. Our focus on fresh and local ingredients, religious dedication to sustainability, passion for serving others, and curated list of the most unique beer, spirits, and cocktails under one roof in the world make every visit a new and compelling experience. We know that in seattle today you have so many choices of where to eat and drink, and are beyond grateful any time you choose us.

cordem.org/SafariDinners



2019

CORD
Cares

Academic Assembly
SEATTLE, WASHINGTON

APRIL 1

6:30 AM

JOIN US FOR A FUN RUN BENEFITING
CORD CARES FOUNDATION
MEET IN THE 7TH FLOOR LOBBY AREA
CHECK-IN BEGINS AT 6:00 AM

SIGN UP CORDEM.ORG/AA
OR AT REGISTRATION DESK

Pre-Day Saturday, March 30, 2019

MERC

7:30 AM – 12:00 PM

MERC1: Formulating Research Questions & Designing Studies

Faculty: Sheila Chauvin, PhD, MEd

In this workshop, participants will brainstorm research ideas, write, and refine a measurable research question. They will discuss when IRB approval is required for their study. The basics of research design will be discussed and applied to their selected research question. Participants will be able to:

- Write a FINER (feasible, interesting, novel, ethical, relevant) educational research question;
- Specify an educational research area of interest;
- Evaluate whether they need IRB approval for their study;
- Select the correct design for their research question

1:00 PM – 5:00 PM

MERC2: Searching & Evaluating Medical Education Literature

Faculty: Sheila Chauvin, PhD, MEd

This workshop is intended for individuals, medical educators, and clinician educators who want to learn how to effectively search the published medical education literature and to evaluate the value of those searches. After participating in this workshop, learners will be able to:

- Formulate an effective approach to searching the medical education literature
- Conduct a search using relevant MeSH headings
- Communicate effectively with a research librarian
- Evaluate the search results using specific review criteria

Day One Sunday, March 31, 2019

KEYNOTE Session

1:30 PM — 2:30 PM

Keynote

Faculty: Judith Tintinalli, MD, MS

She received her MD from Wayne State University, and completed residency training and received her MPH from the University of Michigan in Ann Arbor. Dr. Tintinalli was the founding president of the Council of Emergency Medicine Residency Directors.

MERC

8:45 AM – 12:00 PM

MERC3: Introduction to Qualitative Data Collection Methods

Faculty: Sheila Chauvin, PhD, MEd

This workshop is intended for physicians and generalists in medical education, as well as faculty and staff involved in student affairs, who wish to develop perspectives and skills for collecting qualitative data, such as data from focus group discussions, interviews, observation field notes, and responses to open-ended questions—used in admissions processes, program development, curriculum evaluation, needs assessments, performance evaluation, and various scholarship and research applications. After participating in this workshop, learners will be able to:

- Demonstrate applied knowledge of the appropriate selection, use, and standards for rigor of some common methods for collection of qualitative data

- Generate research questions appropriate for qualitative studies and choose appropriate data collection methods
- Demonstrate applied knowledge of approaches to achieve rigor in the design of qualitative studies and collection of qualitative data
- Demonstrate essential skills required for conducting focus groups

Best Practices (BP)

8:45 AM – 9:15 AM

Positive Feedback Made Viral

Faculty: Kathleen Lee, Lauren Conlon, Amy Waldner

Fostering a positive interprofessional culture is essential to an effective work environment, yet practical and low-cost solutions are difficult to find. This session will introduce a social and mobile platform that leverages digital communication and promotes a real-time positive feedback culture.

9:20 AM – 9:50 AM

330: Novel Evaluations

Faculty: Jeremy Branzetti, Nathan Scott, Danielle Hart, Katja Goldflam, Leah Bright, Stefanie Sebok-Seyer, Michael Gisondi

Evaluation and assessment are a cornerstone of any educational program. As competency-based medical education continues to be the dominant paradigm in medical education, efficient, novel, and effective evaluations become more important. This 330 session will highlight 3 unique sources of evaluations to help keep your learners on track.

- The Patient as Evaluator: Effective Use of Patients in Multi-source Feedback
- Compare methods (and supporting evidence) to involve patients as part of a multi-source feedback program
- Overcome commonly encountered barriers to using patients for feedback
- Interdisciplinary Evaluation of Residents
- Discuss the benefits and challenges of multi-source feedback and how best to relay contentious responses back to the receiving resident
- Accounting for Interdependence in the Team Sport of Patient Care
- Describe the concept of “coupling” and its implications for assessment
- Recognize the significance of evaluating both independent and interdependent aspects of clinical practice

10:15 AM – 10:45 AM

Competency-Based Handovers

Faculty: Holly Caretta-Weyer

Program directors find interns are unprepared for what is expected of them upon entering residency. The AAMC implemented the Core EPAs for Entering Residency to address this. Communicating competency-based data in the post-Match learner handover to GME is the next phase in bridging this transition.

10:50 AM – 11:10 AM

Mind the Gap: A Professional Development Series for Women in EM

Faculty: Abra Fant; PANEL: Allison Marshall, Danielle McCarthy, Priyanka Sista

Gender disparity exists in leadership positions in EM. Cited reasons include lack of mentorship, discomfort with self-promotion and delay in seeking promotion. Our Women’s Night series includes residents, faculty and alumnae from across the city through a series of evening journal clubs/workshops.

11:15 AM – 12:00 PM

Lessons Learned in Medical Education Research

Faculty: Michael Gottlieb, Jaime Jordan, Jeffrey Love, Nicholas Hartman, Laura Hopson

Combined BP & NAW

Educators are expected to produce scholarship, yet many educators struggle with performing research within medical education. This

session will feature a panel of experienced medical education researchers discussing strategies for effectively producing research for the busy educator.

2:45 PM – 3:25 PM

340: Curricular Innovations

Faculty: Jeremy Branzetti, Kamna Balhara, Adriana Olson, Amy Ramsay, Cami Pfennig, Jason Rotoli, Linda Spillane

As the healthcare environment evolves, so must our teaching techniques. In this 340 session, speakers will highlight novel curricular changes they have implemented with the goal of sharing their successes, highlighting the pitfalls, and giving you the necessary tools to bring these innovations to your program.

Room of Horrors

- Understand key concepts of situational awareness and how they apply to emergency medicine and patient safety
- Be able to independently generate an experiential, simulation-based patient safety learning activity incorporating key concepts of situational awareness

Poverty Experience

- Discuss the bidirectional benefit of immersing resident physicians into a community engagement experience.

Community Collaboration for Cultural Awareness

- Highlight some strategies and the critical need to collaborate with community members from different subgroups in simulation to practice the skills required to deliver equitable care to marginalized populations.
- Describe key components of a successful workshop, simulation and assessment by providing examples of workshop development, describing the simulation and debrief session, and identifying which milestones can easily be incorporated into this activity.

3:40 PM – 4:20 PM

It's Not You it's Me: Implicit Bias in Resident Selection and Education

Faculty: Lucienne Luft-Clayton, Caitlin Schrepel, Liza Smith

This didactic will focus on understanding implicit bias and delivering tools to combat it. We will explore implicit bias by contrasting attendee responses to an implicit bias inventory and direct questioning.

4:30 PM – 5:00 PM

Pitfalls in Survey Design and How to Avoid Them

Faculty: Jaime Jordan, Andrew Phillips

Surveys are commonly used in education research; however, educators often succumb to common pitfalls in design, which significantly limit the conclusions that can be drawn from the results. This session aims to identify these pitfalls, describe how to avoid them, and provide best practices in survey design.

Clerkship Directors in Emergency Medicine (CDEM)

8:45 AM – 9:15 AM Coaching Students to Success During Mid-Clerkship Feedback

Faculty: Jose Nable, Jacob Isserman, Janet Smereck, Rahul Bhat

Mid-clerkship formative feedback sessions can be challenging, time-consuming, and awkward. We will present best practices to prime students to succeed during their EM clerkship. Strategies aimed to coach learners of different levels of performance will be highlighted.

9:20 AM – 9:50 AM

Be the Captain of Your Mentor-ship! How to Enhance the Mentee Part of the Relationship

Faculty: Megan Fix

We often discuss mentorship, but what about mentee-ship? Studies show that the mentor-mentee relationship can be enhanced utilizing a “managing up” approach where the mentee takes ownership of the relationship. This session will arm faculty to be better mentor/mentees by utilizing this framework.

10:15 AM – 10:45 AM

I Read About It Online: EM Online Learning Communities

Faculty: Robert Huang, Ryan Buckley, Adam Nicholson, Rob Turer, Oliver Hulland

EM-bound medical students are turning to online learning communities (like SDN and reddit) for advice, mentorship, and support. We will examine how these communities provide camaraderie and a safe space to vent frustrations, and how formal advisors can help students navigate them.

10:50 AM – 11:10 AM

NCAT EM: Two Years of Use

Faculty: Kathy Hiller; PANEL: Jules Jung, Luan Lawson, Doug Franzen

An update of the first year of analysis (second year of use) of the NCAT-EM at the consortium sites. We will be able to provide validity evidence based on 3000+ NCAT-EM forms submitted. Time permitting, we can do assessor development, translating.

11:15 AM – 12:00 PM

Validity Evidence in Emergency Medicine Assessment and Evaluation Tools

Faculty: Kathy Hiller, David Wald, Damon Kuehl, Sarah Ronan-Bentle, Jules Jung, Dana Dunleavy, Michael Beeson

A side-by-side comparison of the tools commonly used by EM educators (USMLE, EM-ACE, National EM M4 exams, SLOE, NCAT, SVI, Milestones, ITE, QE, etc.)

12:00 PM – 1:30 PM

CDEM Mentoring Lunches

Faculty: Sharon Bord, Kendra Parekh

This session will provide CORD attendees the opportunity to network with colleagues as well as senior faculty members within their CDEM area of interest. The room will be divided into various topic tables, such as ultrasound education/social media/new program directors to allow attendees to engage in discussion within their specific field of interest and maximize their experience.

- Connect with leaders within the CDEM and CORD community.
- Discuss pertinent topics within, but not limited to, the CDEM experience.
- Network and collaborate with colleagues

2:45 PM – 3:05 PM

It Takes a Village: Promoting Resident and Faculty Involvement in Medical Student Education

Faculty: Kendra Parekh, Charles Lei, Ryan VanNostrand

Delivering a successful educational program to medical students requires the contributions of many residents and faculty members. In this session, we will discuss strategies for promoting resident and faculty involvement in medical student teaching and mentorship.

3:05 PM – 3:25 PM

It Takes a Village: Engaging Community Based EM Preceptors in an Innovative Model of Medical Education

Faculty: Robert Lam

There has been a marked increase in learners from interdisciplinary backgrounds that seek EM experience in their training. Community based EM preceptors can provide additional resources but are best engaged as part of a program with an innovative education model and based on faculty satisfaction.

3:40 PM – 4:00 PM

Emergency Medicine as a Core Clerkship

Faculty: Melissa Janse, Page Bridges

Historically, Emergency Medicine has not been part of the core clinical curriculum in medical school. We successfully advocated to change this at our school, and our experiences can be used as a guide for others. Here, we provide a “how to” guide for making emergency medicine a core clerkship.

4:00 PM – 4:20 PM**Students, Students Everywhere! How to Incorporate Emergency Medicine Across All Four Years***Faculty: Nicole Dubosh, Ed Ullman*

As medical school curricula continue to bring clinical experiences earlier and earlier in training, there is ample need and opportunity to increase emergency medicine presence in undergraduate medical education.

4:30 PM – 5:00 PM**Goodbye Millennials, Hello Gen Z!***Faculty: Jennifer Jackson, Anne Messman*

As Millennials age, a new generation, GenZ is upon us. This session will compare/contrast Millennials and GenZ through an interactive exercise, reviewing ways to adopt educational content to meet learner needs. This session will include clerkship and residency perspective.

Chief Resident**11:00 AM – 12:00 PM****We Survived! Stories and Lessons from Former Chief Residents***Faculty: Gina Waight PANEL: Raquel Harrison, Brian Wood, Joel Park*

Chief residents often encounter challenging situations that they may have to navigate without formal training. In this discussion, former chief residents will share narratives from their own chief year, describing these challenging moments, how they handled them, and lessons learned.

2:30 PM – 3:45 PM**Innovation and Collaboration: Building Connections Between Chief Residents***Faculty: Fareen Zaver, William Deng, Derek Monette, Katie Wells, Tanner Gronowski, Evan Kuhl*

In this workshop chief residents will participate in facilitated small groups to network, collaborate, and brainstorm common challenges they face in their programs. By participating in the group discussion chief residents will be able to benefit from the shared experiences of their peers at other programs to improve their own institutions.

4:00 PM – 4:30 PM**Towing the Party Line as a Chief Resident***Faculty: David Haider, Shannon Toohey*

In this presentation, you will hear from both a faculty member and a resident regarding the various (and sometimes conflicting) expectations of a chief resident. This presentation will be formatted as a back and forth between an APD and resident discussing what qualities leadership looks for when selecting chief residents and what their peers generally expect. We will aim to highlight the various hats we expect our chiefs to wear and plan for a Q&A at the end.

4:30 PM – 5:00 PM**Chief Hacks***Faculty: Viral Patel, Richard Church*

This session is intended to discuss common questions that arise for chief residents and issues that outgoing chiefs describe as things they wish they knew prior to assuming their role.

Emergency Medicine Association of Residency Coordinators (EMARC)**8:45 AM – 9:15 AM****Welcome & Networking***Faculty: Jana Ricker, Melanie Pigott***9:20 AM – 9:50 AM****Coordinators — Spotting a Resident in Distress***Faculty: Michele Dorfsman, MD, Larissa Lindquist, Michele Dorfsman, MD, Larissa Lindquist*

The session is designed to provide participants with pearls on identifying trainees who may be at risk for depression, anxiety, suicide, substance abuse, or other risky behaviors. The speakers have experience in working with trainees with depression with suicidal ideation, among other stressors, and will share real-life experiences.

10:25 AM – 11:10 AM**Talk Techy To Me***Faculty: Melanie Pigott, Jessica Burkhalter, & Patrick O'Brien*

Let's talk tech! A panel discussion on technology available to Program Coordinators — in particular QR codes (Quick Response Codes). We will focus on what QR codes are, how they can make the coordinator's life easier, and how it can enhance a program's efficiency in document management.

11:15 AM – 12:15 PM**EMARC — Where Do We Go From Here? OUR Future is NOW — Are YOU Ready???***Faculty: Michael Epter*

Throughout the years there have been many adaptations within CORD as an organization and also within EMARC. The session will be led by CORD's Immediate Past President along with a past & current EMARC BOD liaison and will be OUR opportunity to discuss what makes us outstanding and where we have opportunities for improvement in order to unleash the potential we have. When you leave this workshop you will have helped to set the path for our future — are you ready?

12:45 PM – 1:30 PM**Working Smarter with SmartSheets***Faculty: Ryan Van Otten*

Through the use of Smartsheet, a software service application for collaboration and work management, we have been increasingly successful in managing and organizing our educational programs.

2:45 PM – 3:25 PM**The ACGME Site Visit: Knock It Out of the Park***Faculty: Richard Bounds, Vicki Noble, Jenna Fredette*

Preparing for an ACGME site visit, for either initial or continued accreditation, requires countless hours of work, attention to detail, and thoughtful delegation to team members. This session will provide tips for success, with a panel discussion that includes program leaders who have recently completed their site visits. Here how these PDs prepared, what lessons they learned along the way, and how to get your staff and residents on board with a positive message. Speakers will offer an approach with an organizational framework and timeline, tasks for delegation to faculty, preparation materials for dissemination of information, and strategies for engaging key stakeholders. At the end of this session, attendees should have a clear idea of what is required of an ACGME site review, and how to best prepare.

3:40 PM – 4:40 PM**Practical Advice for Coordinators: Completing the ADS Annual Update***Faculty: Kandice McLeod*

Practical advice given to coordinators on how to navigate the ADS Annual Update with minimal to no errors. Explanation and walkthrough given in each area of the ADS update and explanations as to common reporting errors that can potentially result in adverse action against the program by the ACGME.

4:50 PM – 5:00 PM

How Much Conference Does It Take?

Faculty: Matthew Hysell, Matthew Hysell, MD

Residents frequently start to fall short of the 70% required conference attendance rate. The next question that arises is how many they have to attend to reach 70%. This presentation will demonstrate a simple formula to provide the answer. It can also be inputted into an excel spreadsheet.

iMedEd

8:45 AM – 9:15 AM

So You Want to be an Entrepreneur?

Faculty: Adam Rosh

A dream is something you fantasize about that may never happen. A goal is something you set a plan for, work toward, and achieve. This session will help you set goals, provide you the tools to get started as an entrepreneur, and help turn your idea into a business.

9:20 AM – 9:50 AM

The Future of Medical Education

Faculty: Felix Ankel

How can we prepare for the future? What is signal and what is noise? Knowledge is expanding at an exponential rate and we are using traditional linear techniques to learn it. While Augmented Intelligence (AI) will not replace physicians; physicians who don't use AI will be replaced by those who do. Professional future identities are changing. This session will provide an overview of future casting as a model and method for anticipating the future. We will explore the role and relationships between and among knowledge, agents and networks in health professions education.

10:15 AM – 10:45 AM

How to Build a Culture of Innovation in Your ED

Faculty: Paul Casey

This session will discuss strategies for building a culture of innovation and continuous improvement in your department. We will introduce fundamental quality improvement tools and discuss successful approaches to change management. We will also discuss the application of lean management philosophy to drive a culture of experimentation and daily improvements.

10:50 AM – 11:10 AM

What's up with What's App? Managing Residency Dynamics in the Era of the Group Chat

Faculty: Robert Huang, Adam Nicholson

Group chat platforms (What's app, Group me, and iMessage) have become a popular method of communication. This session will discuss the benefits (rapid/convenient communication, group bonding) and potential harms (lack of professionalism, negative impact on morale) on residency dynamics.

11:15 AM – 12:00 PM

How to Have a Successful Residency Social Media Program

Faculty: Zack Repanshek, Jennifer Repanshek, Alisha Brown

The rising popularity of social media for both professional and personal purposes is undeniable. However, its presence creates new challenges for junior physicians from both a professional and ethical standpoint. As educators, we must play an active role in guiding and advising them how to be lifelong learners and excellent stewards of social media. In 2014, CORD made a strong recommendation that each emergency medicine residency program develop a social media policy and education effort. Achieving this goal may seem like a daunting task, but there are solutions to creating successful social media platforms as part of a residency program. We present our experiences implementing a social media curriculum at two different institutions.

2:45 PM – 3:25 PM

When Tech Fails: Technology Isn't Always the Answer

Faculty: Dimitri Papanagnou, Eric Shappell

This session will cover common pitfalls encountered when integrating technology into education interventions and how to avoid them, including alternative educational strategies.

3:40 PM – 5:00 PM

Open House

Faculty: Michael Gottlieb, Fareen Zaver, Michael Barrie, Tanner Gronowski, Katarzyna Gore, Matthew Klein, Scott Witt, Chris Gaafary, Glenn Paetow, Andy Little

Attendees will get hands-on explanations and tutorials about cutting-edge technology that they can apply to facilitate their teaching. The Technology Open house will feature experts who will teach participants about Virtual Reality, Slack, Evernote, Mendeley, Screencasting, Google Hangout, and AirTable. The experts will be available to discuss the tools and how to use them throughout the entire session. Participants can go to areas that are of most interest to them for hands-on training sessions.

Navigating the Academic Waters (NAW)

8:45 AM – 9:15 AM

How to Conference

Faculty: Collyn Murray, Jason Wagner

First time at a conference? This session serves as an introduction to the ins-and-outs of attending academic conferences. Directed at novice conference goers, the session will focus on planning conference days, capitalizing on limited sessions, networking, and finding freebies in a "how to" review.

9:20 AM – 9:50 AM

Steering the Ship Without Driving: Chief Residents and Program Directors Give and Take in Academic Conferences

Faculty: Thomas Perera, Matthew Nelson

Every year chief residents come in with great ideas and a desire to change residency conference. However, program leadership must ensure that the appropriate content is delivered. This talk will explore how to encourage the enthusiasm for change while maintaining sound educational practices.

10:15 AM – 11:10 AM

460 Mentorship

Faculty: Edward Ullman, Andrew Ketterer, Leah Bright, Linda Regan, James Ahn, Edward Ullman, Caroline Dowers, Namita Jayaprakash

Mentorship is a challenging and infrequently taught, yet crucial skill in academic medicine. This rapid-fire session is a 360 approach to the mentor/mentee relationship.

- Discover hacks to grow your current relationships as a mentee
- Collaborate with current colleagues to enhance mentorship within your program utilizing the "Teaching College" model
- Learn when to say yes, and (more importantly) when to say no
- Appreciate unique aspects of mentoring the millennial generation

11:15 AM – 12:00 PM

Lessons Learned in Medical Education Research

Faculty: Michael Gottlieb, Jaime Jordan, Jeffrey Love, Nicholas Hartman, Laura Hopson

Educators are expected to produce scholarship, yet many educators struggle with performing research within medical education. This session will feature a panel of experienced medical education researchers discussing strategies for effectively producing research for the busy educator.

2:45 PM – 3:05 PM**How to Get What You Need: Designing and Conducting an Effective Needs Assessment***Faculty: Laura Hopson*

Essential to designing an effective curriculum, solving a problem, or programmatic change is to understand the current state. This session will guide participants through the steps of executing a needs assessment.

3:05 PM – 3:25 PM**A “How to” Guide for Qualitative Analysis: Use, Interpretation, Successful Implementation***Faculty: Laura Hopson, Jaime Jordan, Lainie Yarris*

Qualitative research provides a unique opportunity to define questions around educational topics. Used appropriately, it provides a springboard into additional research questions. This session will introduce approaches, techniques, strengths, and limitations as well as tips for success.

3:40 PM – 4:20 PM**Time Management 440***Faculty: Jason Wagner, Taher Vohra, Todd Taylor, Brett Todd, SueLin Hilbert, Adam Rieves*

We are often the biggest obstacle to our own success. Tasks that bring us the most satisfaction or are essential to academic advancement end up towards the bottom of our to do list. This session will help you prioritize the items on your over-flowing plate of To-Do's. Talks will build the foundational theory behind time and task management, move to techniques to improve efficiency, and finally discuss apps that will help you implement the discussed frameworks into your everyday life.

- Learn the latest time-management strategies.
- Understand the key components of a productivity system.
- Learn components of a personal organization system for tasks and documents.
- Discover the obstacles we place in the way of our success, and how to overcome them.

4:30 PM – 5:00 PM**Pitfalls in Survey Design and How to Avoid Them***Faculty: Jaime Jordan, Andrew Phillips*

Surveys are commonly used in education research; however, educators often succumb to common pitfalls in design, which significantly limit the conclusions that can be drawn from the results. This session aims to identify these pitfalls, describe how to avoid them, and provide best practices in survey design.

New Programs & Leaders (NPL)**8:45 AM – 9:50 AM****Inside the RRC***Faculty: Edward Stettner; PANEL: Phillip Shayne, Wallace Carter, Christine Sullivan, Suzanne White*

A panel discussion with former members of the RRC about what goes in to the accreditation decision and site visits.

10:15 AM – 11:10 AM**560: Curricular Creation & Design***Faculty: David Duong, Jordan Spector, James Waymack, Brian Wood, Katja Goldflam, Christina Shenvi, Timothy Fallon, Megan Stobart-Gallagher, Chaiya Laoteppitaks*

These 560 sessions will help the new residency program or a new PD or APD create successful curricular components to your program, or help you buff and shine what you already have. Check out some of these “tricks of the trade” in curriculum development for the EM residency program.

- Develop a basic quality curriculum for residency education that can integrate with hospital and community partners to achieve

quality and patient safety education and generate scholarly activity from quality and patient safety projects through collaboration and organization

- Describe a model of resident-faculty teams in planning didactics with benefits of these teams for both residents and faculty
- Present specific ways to involve faculty, pharmacists, nurses, and patients into conference in a meaningful manner and discuss the importance of recognition of effort to faculty engagement, and ways to provide it practically.
- Provide examples of successful curricular innovations that can be easily implemented with limited structural change to the didactic schedule and need for faculty participation and enhance resident participation, engagement, and satisfaction.
- Use the principles of cognitive load theory during clinical teaching to maximize learning.
- Develop a working understanding of the principles cognitive load theory.

11:15 AM – 12:00 PM**Anatomy of the CCC***Faculty: Eric Steinberg, David Carlberg, Timothy Fallon*

APDs are responsible for running Clinical Competency Committee (CCC) semiannual meetings, yet sometimes are provided little guidance on how to run them efficiently and effectively. CCC meetings can be fraught with non-productive discussion, hurt feelings, and wasted time. This session is directed toward new leaders who want practical tips and advice, before, during, and after the actual CCC meeting.

2:45 PM – 3:25 PM**The ACGME Site Visit: Knock It Out of the Park***Faculty: Richard Bounds, Vicki Noble, Jenna Fredette*

Preparing for an ACGME site visit, for either initial or continued accreditation, requires countless hours of work, attention to detail, and thoughtful delegation to team members. This session will provide tips for success, with a panel discussion that includes program leaders who have recently completed their site visits. Here how these PDs prepared, what lessons they learned along the way, and how to get your staff and residents on board with a positive message. Speakers will offer an approach with an organizational framework and timeline, tasks for delegation to faculty, preparation materials for dissemination of information, and strategies for engaging key stakeholders. At the end of this session, attendees should have a clear idea of what is required of an ACGME site review, and how to best prepare.

3:40 PM – 4:20 PM**Emergency Medicine Residents: Bias in Feedback***Faculty: Mira Mamtani PANEL: Lalena Yarris; Fiona Gallahue; Kevin Scott*

Delivering effective feedback remains challenging with studies indicating that conscious and unconscious biases can play a role in the feedback process. Furthermore, literature suggests that these biases can affect the training, career selection, and advancement of certain groups of people. This session will be a collaborative multi-site approach to understanding, acknowledging and addressing biases in feedback. Speakers plan to share some literature on the prevalence and impact of bias in graduate medical education, followed by a panel discussion of strategies.

4:30 PM – 5:00 PM

Program Leadership Lessons

Faculty: Philip Shayne

Dr. Shayne will share experiences and lessons learned across multiple leadership positions:

- Lessons on how to develop and lead teams
- To offer lessons to those on a similar path.

Resident

8:45 AM – 9:25 AM

Fellowship or Bust

Faculty: Holly Caretta-Wyer, Paul Kukulski; PANEL: Lindsay Flax; Adaira Landry; Kendra Parekh

In this panel session, a diverse group of faculty members and recent graduates will discuss considerations in the decision to pursue a fellowship or academic position after residency. We will address important questions such as: Is a fellowship important to reach my career goals? What resources are available to someone who is trying to decide on a fellowship? What is it like to stay at one's own institution, versus going to a new program for fellowship? What certificates or advanced degree options are available post-residency, and what are their benefits?

9:25 AM – 9:55 AM

Resident Finances 101

Faculty: Eric Shappell, Ryan McKillip

Should you use that extra money to invest or pay down loans? This session will cover common financial issues that residents face, including loan repayment strategies, disability insurance, investing, and financial advisors. The session will begin with general strategies and conclude with a brief Q&A to allow for targeted questions.

10:15 AM – 11:00 AM

Work Deep, Get Productive! 10 Tips for Ramping up Your Research

Faculty: Michael Gottlieb

In the era of constant e-mails, "pings," and smartphone alerts, it can be difficult for residents to make progress on cognitively challenging tasks, such as research or scholarly writing. This session will introduce attendees to the idea of "deep work," and review 10 easy-to-implement strategies to increase your productivity.

11:15 AM – 12:00 PM

Riding The Waves: Tips to Flourishing in Residency, Both Personally and Professionally

Faculty: Farhad Aziz, Andrew King, Christopher Doty, Geremiha Emerson, Simiao Li-Sauerwine, Lauren Branditz, Carolyn Martinez

Burnout is real. In recent years, the focus on wellness in emergency medicine has taken center stage. However, how are residents really coping with residency? What are residents and their programs doing to help? This will be a faculty-led small group discussion on different topics that pertain to resident wellbeing, with time for breakout small group discussions with colleagues.

2:45 PM – 3:15 PM

Teaching "On the Fly"

Faculty: Tyson Pillow, Moises Gallegos; Jeff Liu

This session will explore a variety of methods that residents can use to engage medical students or junior residents to engage learners, teach effectively, and create an environment of learning during otherwise busy clinical shifts.

3:15 PM – 3:45 PM

Mentoring Medical Students as a Resident

Faculty: Jaron Soulek, Julie Dodson, Brian Milman

In this lecture, we will explore ideas and techniques for serving as a mentor to medical students as a resident, with the goal of contributing to the educational experience of medical students.

4:00 PM – 5:00 PM

Killing it (Softly): How to be the Resident Every PD Wishes They Matched

Faculty: Aleksandr Tichter; Lynn Jiang; Margaret Goodrich; Nida Degeysys

In this session, we will provide a roadmap for becoming a standout resident. From the obvious to the occult – learn the strategies that will optimize your success and help you get the most out of your training experience.

**Day Two
Monday, April 1, 2019**

Specialty

7:00 AM – 8:00 AM

How to Get Involved with CORD

Faculty: Christopher Doty

Ever wonder how folks become a track chair, board member or other leader in CORD? Mostly it is just a matter of putting up your hand and being willing to do a little extra. However, for a few more details, come chat over breakfast with Chris Doty as he shares with you some thoughts on getting involved in CORD.

8:00 AM – 10:00 AM

Remediation Consult Service

Faculty: Kelly Williamson

The remediation task force (RTF) offers a consult service to aid CORD members with challenging remediation processes. This session offers an in-person consultation service with members of the RTF. Participants can bring their questions, problem cases, or a listening ear and receive recommendations.

10:00 AM – 12:00 PM

Diversity Consult Service

Faculty: Jeremy Branzetti

Diversity is an ongoing problem with emergency medicine training and practice without easy solutions. Using the success of the Remediation Consult model, a Diversity Consult service of experts can be created to help programs with their specific diversity challenges. Programs will be asked to submit their diversity-related challenges to the committee and received collective feedback on recommended actions.

11:30 AM – 1:00 PM

Education Research Consult Service

Faculty: Jaime Jordan

12:00 PM – 1:00 PM

ASC-EM Advisor Consult Service

The Advising Students Committee in EM (ASC-EM) offers a live consult service to answer specific questions related to advising individual students, advising non-traditional students or student groups, and general advising concerns. Advisors can bring questions related to applicant advising challenges they face, and receive advice from an experienced panel of PDs, CDs, and advisors.

1:00 PM – 5:00 PM

Mini Fellowship in Wellness Leadership

Best Practices (BP)**8:00 AM – 8:30 AM****CCC Squared: Creating a Constructive and Comprehensive CCC***Faculty: Michael Ehmann, Linda Regan, Leah Bright, Logan Weygandt, Christina Tarleton*

Combined BP & EMARC

A description of the iterative process to improve the efficiency of our program's biannual CCC reviews. We will share how we streamlined our process to comprehensively review our 48 residents' clinical competency in one 8-hour meeting every 6 months.

8:30 AM – 9:00 AM**Education Journal Club***Faculty: Esther Chen, David Duong, David Gordon*

Combined BP & CDEM

Do you find it challenging to keep up with the latest and greatest in medical education? This session will review the most pertinent medical education articles of 2018.

9:10 AM – 10:15 AM**Torpedo's in the Water: Getting Sunk By a SLOE-pedo***Faculty: Adam Kellogg, Tom Morrissey, Jamie Shandro, Emily Hillman*

Combined BP & CDEM

An interactive session including examples from actual, de-identified SLOEs, where we discuss writing fair SLOEs for the less competitive. We will also discuss advising students recognized to have a "SLOEpedo" in their application.

10:20 AM – 11:00 AM**Winning the P&T Game: How to Optimize Your Time Management for Academic Productivity***Faculty: Holly Caretta-Weyer, David Jones*

Scholarship is required for promotion; however, medical educators have an enormous amount of demands on their time that prevent scholarship from occurring. In this session, we will develop a time management system that takes into account both current time demands and education scholarship goals.

11:00 AM – 12:00 PM**Curricular Innovations 560***Faculty: Rebecca Bavolek, Leah Bright, Michael Barrie, Timothy Koboldt, Christina Shenvi, Amita Sudhir, Charlotte Lawson, W. Gannon Sungar*

This session will be a rapid fire of innovations to give some unique ideas on how to teach difficult topics and how to solve some of those didactic issues that many programs commonly face.

Clerkship Directors in Emergency Medicine (CDEM)**8:00 AM – 8:30 AM****Giving Real-Time Feedback to Students: Coaching Your Students to Their Personal Best***Faculty: Jay Ladde, Josef Thundiyil*

National surveys suggest that 8% of learners are satisfied with feedback. Feedback that is specific, timely, and supportive helps reinforce desired actions. By creating this dialogue, educators will be able to provide real-time feedback while maintaining close working relationships with students.

8:30 AM – 9:00 AM**Education Journal Club***Faculty: Esther Chen, David Duong, David Gordon*

Combined BP & CDEM

Do you find it challenging to keep up with the latest and greatest in medical education? This session will review the most pertinent medical education articles of 2018.

9:10 AM – 10:15 AM**Torpedoes in the Water: Getting Sunk by a SLOEpedo***Faculty: Adam Kellogg, Emily Hillman, Jamie Shandro, Tom Morrissey*
Combined BP & CDEM

An interactive session including examples from actual, de-identified SLOEs, where we discuss writing fair SLOEs for the less competitive. We will also discuss advising students recognized to have a "SLOEpedo" in their application.

10:20 AM – 11:00 AM**The Data and The Deeds To Be Done***Faculty: Lucienne Lufty-Clayton, Doug Franzen; Zach Jarou; Mike Kiemeny* PANEL: Kendra Parekh, Trevor Pour

This didactic will focus on understanding the steps made this past year by the Application Process Improvement Committee. We will then transition to a small group activity to actively brainstorm other ideas to help positively impact the application process.

11:00 AM – 12:00 PM**560: Advising Special Populations***Faculty: Alexis Pelletier-Bui, Caitlin Schrepel, Kyle Couperus, Jose Nable, George Willis, Liza Smith, Doug Franzen*

This 560 session will present evidence based recommendations and expert opinion for advising special applicant populations including military applicants, couples matching, URMs, orphan programs, and dual accreditation. This session is presented on behalf of CORD's ASC EM (Advising Students Committee Emergency Medicine).

Emergency Medicine Association of Residency Coordinators (EMARC)**8:00 AM – 8:30 AM****CCC Squared: Creating a Constructive and Comprehensive CCC***Faculty: Michael Ehmann* PANEL: Linda Regan, Leah Bright, Logan Weygandt, Christina Tarleton

Combined BP & EMARC

A description of the iterative process to improve the efficiency of our program's biannual CCC reviews. We will share how we streamlined our process to comprehensively review our 48 residents' clinical competency in one 8-hour meeting every 6 months.

8:30 AM – 9:00 AM**EMARC Business Meeting***Faculty: Melanie Pigott, Jana Ricker*

Open to all EMARC members (how to get involved, what is EMARC up to, what do you want from EMARC)

9:10 AM – 9:40 AM**EMARC Track Planning**

EMARC Track planning for CORD Academic Assembly 2020!

9:45 AM – 10:15 AM**Coordinator Wellness***Faculty: Sophia Ioff*

A brief overview of strategies that promote wellness during working hours and at home.

10:20 AM – 11:15 AM**Program Director Loss: How A Program Rallied Together After The Unexpected Loss of Their Beloved Program Director***Faculty: Ann Hill; Stacie Miller; Mary McNatt*

The sudden loss of a program director can be devastating. This session will show how an emergency medicine residency program came together to support each other as a "family." We will also discuss how we continue to keep our PD's legacy alive and continue their work in Emergency Medicine.

11:15 AM – 12:00 PM

PCPC- Program Coordinator Presentation Case

Faculty: Patrick O'Brien

A Residency Coordinator will put forth an administrative issue with a resident and explore the problem with the audience as a group, showing the collaboration of residency program leadership in handling a resident-related administrative issue.

iMedEd

8:00 AM – 8:30 AM

Maintaining Engagement on Social Media Platforms

Faculty: Derek Monette; Nikita Joshi; Matt Klein

Emergency medicine has led the charge for incorporating social media into our education and practice. But amid a sea of competing personal and professional demands, is it worth the effort to keep logging on? In this session, we highlight some of the ways by which social media may enhance your career and share practical strategies for maintaining engagement, or for becoming reengaged. After this session, participants should be able to: Recognize motivations for maintaining engagement with social media, including brand management and knowledge translation. Identify strategies for cutting through "the noise" on social media, finding online communities, and maintaining engagement. Identify a practical, balanced approach to incorporating social media into your daily or weekly routine while preventing "click fatigue."

8:30 AM – 9:10 AM

Needle in a Haystack: How to Find and Evaluate Quality FOAM

Faculty: Fareen Zaver, Andy Grock, Teresa Chan, Mike Gottlieb

There are a multitude of blogs and podcasts available that provide Emergency Medicine educational content, but how do you know which ones are educationally sound? In this workshop, you will learn how to define quality within blogs and podcasts. You will then apply the skills to help find, curate, and evaluate educational content that is available online. Ultimately, these skills gained from this workshop can be used in your program to ensure that your learners are using effective educational content to learn.

9:20 AM – 9:40 AM

Taking Control of Your Social Media Profile

Faculty: Rob Cooney

This session will familiarize attendees with the common social media platforms and introduce strategies that will help them to control the profile of their programs and themselves as individuals.

9:45 AM – 10:15 AM

Developing and Refining Your Online Presence: A Hands-On Workshop

Faculty: Robert Cooney, Michael Gottlieb, Fareen Zaver, Teresa Chan, Nikita Joshi

This session is designed for participants to begin to develop an online identity. We will explore the use of common social platforms and how these can be used to create a personal "brand." Participants will become familiar with tools that assist with content creation and distribution.

10:20 AM – 11:00 AM

How To Build Your Residency Brand

Faculty: Mike Gisondi, Jeremy Branzetti

In this session, attendees will learn the key principles of branding for educational programs. Brand image and brand experience will be discussed at the training program and department levels. The presentation will focus on the successful recruitment of residency and fellowship candidates.

11:05 AM – 12:00 PM

How to Utilize Social Media for Promotion and Tenure

Faculty: Mike Gisondi, Jennifer Beck Esmay, Felix Ankel

The promotions and tenure (P&T) process is important for all academics as they progress through their career. To succeed, one must showcase their scholarship in ways that are understandable to the P&T committee. Understanding the process of how to navigate the P&T process with scholarship that is increasingly digital (i.e., blogs, podcasts) is critical. While every institution has their own system, best practices are emerging for this process.

Navigating the Academic Waters (NAW)

8:00 AM – 8:30 AM

Imposter Syndrome: Getting Out of Your Own Way

Faculty: Fareen Zaver; Natasha Wheaton

PANEL: Jaime Hope, Arlene Chung, Rebecca Bavolek

Imposter phenomenon (IP) is a common entity and is a significant impediment to the professional development of both residents and faculty. We will review the current literature and research on Imposter Syndrome. We will then discuss how to identify IP and present coaching methods with tangible solutions to assist individuals in overcoming this barrier to achieve their full professional potential.

8:30 AM – 9:00 AM

Going Public: Getting Your Message Out to the Masses

Faculty: Jeremy Faust

This lecture will be described how to pitch, write, and promote articles about emergency medicine and related topics (including Op-Eds) for mainstream media outlets. Specific focus will be on the tried-and-true structures that writers can rely on, and editors love.

9:10 AM – 9:40 AM

Affiliate Sites: Careers in Education Outside the House of Medicine

Faculty: Caitlin Bailey

Many new and recent residency graduates are interested in medical education, but unsure if they wish to pursue a position in a university setting. This talk will describe career tracks involving medical education outside the traditional house of medicine. Examples will include county sites, community rotation site directorships, elective rotation leadership, and more.

9:45 AM – 10:15 AM

When Program Leadership and Parenting Collide

Faculty: Suelin Hilbert

How being an APD prepared me for motherhood and how I learned to be more supportive of residents and faculty as new parents.

11:00 AM – 12:00 PM

560: Mastering Your EM Identity

Faculty: Edward Ullman, Christina Shenvi, Simran Buttar,

Dimitrios Papanagnou, Anne Messman, Gannon Sungar,

Jan Schoenberger, Edward Ullman, Rochelle Zarzar

Making the leap from resident or fellow to junior faculty is often the beginning of a journey without a map. This 560 session will give crucial tips to a successful launch of your academic career.

- Gain an understanding of the concept of managing up as an active engagement
- Understand and increase awareness of your own "dark side" traits.- Identify core areas for personal development necessary to succeed as junior faculty.
- Techniques to assist in developing a "niche" to progress your academic career.
- Understand the concept of reframing and how it applies to leadership.

New Programs & Leaders (NPL)

8:00 AM – 8:30 AM

The Basics of Starting a New Residency Program

Faculty: Moshe Weizberg; Fiona Gallahue

A discussion to provide “all the basic tools one will need, to help develop faculty skills and ensure the creation of a stellar EM residency program. The speakers have both started new residency programs and are now established residency directors. They will share their experiences to share some tools to assist other new PDs as they build a new program. Speakers will also provide a handout on faculty development techniques.

8:30 AM – 9:00 AM

Teaching Culturally Responsive Care

Faculty: Glenn Paetow, Aarti Jain, Nate Scott, Rochelle Zarzar

This didactic session presents five unique methods for teaching culturally responsive care along with the learner outcome objectives in the cognitive and affective domains. Speakers will present real-world experiences along with the pearls and pitfalls of adapting these techniques to residency education. Presentation will be combined effort on lecture – alternating speakers

9:10 AM – 9:40 AM

Expanding Your Reach — Virtual Mentorship

Faculty: Maria Moreira; Saadia Akhtar

Mentorship is important for growth and career advancement. There are times when perhaps the best mentorship for you may be at a distance. This session will provide those seeking to be virtual mentor’s information on how to do so and also information on the pitfalls and advantages of this type of mentorship. For those seeking mentors, this will provide them with another potential avenue for mentorship.

9:45 AM – 10:15 AM

Our Collective Experience: Pearls and Pitfalls of Foundations Implementation

Faculty: Kristen Grabow Moore, Natasha Wheaton, Jeremy Berberian

“Foundations of Emergency Medicine” is a web-based learning resource for emergency medicine, offering a series of courses that are openly shared with EM residency programs around the USA. More than 120 residency programs have incorporated the Foundations curriculum in their training programs, and the body of knowledge and experience from Foundations site leaders has grown exponentially. In this session, diverse program leaders will share their perspectives and advice for making use of Foundations course resources and successful implementation at any program.

10:20 AM – 11:00 AM

How to Facilitate a Small Group Session

Faculty: Nicholas Hartman, Jaime Jordan, Lisa Moreno-Walton; Michael Gottlieb

Small group discussions form an essential component of instruction for EM learners. Many faculty are often thrust into the role of leading small groups without much formal training in how to do this best. This session will relay best practices; to help teach in ways that promote active engagement in learners – to address common issues (e.g. leaders who give answers, or who guide in a way that is too heavy handed or learners who have difficulty sticking to the ground rules, who interrupt, who dominate discussion, etc.) This session will provide leadership guidance and examples, and ways to deal with common issues.

11:00 AM – 12:00 PM

560: Beyond Nuts and Bolts

Faculty: David Duong, Jordan Spector, Elizabeth Gignac, Peter Moffett, William Peterson, Joseph House, Gene Hern, David Duong, Angela Chen, Loice Swisher

These 560 sessions will offer solutions to several challenges a program director or an APD may encounter when starting or maintaining an EM training program. Speakers will offer ideas to help you recruit talented learners, to provide learners effective feedback, and to promote wellness. Check out these creative ideas to address common issues not addressed elsewhere — beyond the nuts and bolts!

Resident

8:00 AM – 8:45 AM

Let's Be Real, You Need a Job Now

Faculty: Edward Lew, Tara Kenny

This session is intended to provide exposure to the different models and types of hospital jobs in the academic, community, and county settings. This session will help participants understand how different practice models affect financial planning and how your clinical practice changes with different hospital types.

9:00 AM – 9:40 AM

How to Succeed Your First Year Out

Faculty: Christine Shenvi, Nikki Binz

In this session, attendees will learn about ways to avoid career ending pitfalls as fresh new attendings. This session will shed light on situations that could make life difficult at your first job out — including burning bridges with ancillary staff, unwise financial decisions, and being locked into a restrictive contract. We'll also talk about the positive things: how to set yourself up for success in your practice, your personal well-being, and your chosen career path!

9:45 AM – 10:15 AM

Social Media Snafus: Could You be Next?

Faculty: Sara Paradise; Christian Ruiz

Whether a personal Instagram post, Twitter battle, or Facebook video outburst, we've all seen physicians in the national limelight for some not-so-positive reasons. In this session, we will highlight a few of these case examples and review why a social media post may not be so innocuous.

10:20 AM – 11:00 AM

How to Get Where You're Going and Lead While Doing It!

Faculty: Alicia Kurtz, Dhimitri Nikolla, Derek Monette

Do you ever wonder what it would be like to impact emergency medicine on a national level as a resident? In this session, attendees will hear from former resident superstars on how they got involved and thrived in emergency medicine on a national level, followed by Q&A.

11:15 AM – 12:00 PM

CV Workshop

Faculty: Michael Epter

In this session, attendees will initially learn about the characteristics of a high-quality CV to improve your hire-ability. This talk will be followed by a CV workshop so attendees can receive real time feedback.

Research

12:00 PM – 1:00 PM

Educational Soundbites

Faculty: Bo Burns, Jeffrey Siegelman

New educational innovations are developed every year by creative faculty who design fresh ways to improve their didactics, bedside teaching, and procedural skill training. In this session selected presenters will discuss their novel approaches and educational solutions.

5:00 PM – 6:30 PM

Moderated Poster Session

Faculty: Boyd Burns, Jeffrey Siegelman
Moderated Poster Session

Day Three
Tuesday, April 2, 2019

Specialty

9:00 AM – 10:30 AM

CORD Business Meeting

Faculty: Christopher Doty
The CORD Business and Membership Meeting.

10:45 AM – 12:00 PM

RRC Update & Q&A

Faculty: Douglas McGee

6:00 PM – 8:00 PM

CORD Closing Reception

Museum of Pop Culture

Best Practices (BP)

8:00 AM – 8:25 AM

Social Emergency Medicine: Creating a Curriculum for Physician Advocates and Holistic Providers in the 21st Century

Faculty: Fiona Gallahue, Annie Chipman, Callan Fockele, Harrison Alter

Social EM (SEM) is an emerging area focused on understanding our patients' context. EM providers confront the social determinants of health, but receive little dedicated education. We address this curricular gap by defining SEM, compare 2 existing curricula, and demonstrate how to create a curriculum.

8:25 AM – 8:50 AM

Teaching Clinical Efficiency: Tapping into a Learner's Full Potential!

Faculty: Guy Carmelli, Mark Silverberg

Teaching efficiency, the art of maximizing productivity while minimizing wasted energy and time, is uncommon amongst EM programs. This session will define clinical efficiency, discuss supporting research, offer up ways to measure it, and discuss ways to incorporate teachings on efficiency into your curriculum.

1:30 PM – 2:35 PM

Coaching Residents: Competencies and Insights From Professional Coaches

Faculty: Melissa Platt, Magdalena Robak, Natasha Wheaton, Jeremy Branzetti, Dana Ferguson

Combined BP & NPL

While we often use the term "mentoring" many of our contacts with residents as educational faculty are in fact, examples of coaching. This talk highlights the recent focus on "coaching" as a valuable construct for learner development in medical education. The speakers will cull through the best of coaching advice from the sports literature and relate it to the professional coaching of our residents. This talk goes straight to the source, gaining insight into coaching practices from professional coaches, drawing from advice and philosophies of famous Hall of Fame coaches.

2:45 PM – 3:15 PM

Reaching the Reticent — Coaching Faculty to Make On-Shift Teaching Work

Faculty: Jamie Shandro, Laura Welsh

Every faculty member has the potential to foster on-shift teaching while balancing busy patient care. We will discuss common barriers to on-shift teaching, and outline coaching strategies to motivate and engage faculty to develop a personalized approach to make working with learners rewarding.

3:30 PM – 4:10 PM

Do Opposites Attract? Strategies for Effective Peer Coaching Programs

Faculty: Joshua Wallenstein, Jeffrey Siegelman, Todd Taylor, Michelle Lall, James O'Shea

Peer coaching is a highly effective skill not often included in faculty development programs. Facilitating audience engagement in mini-peer coaching sessions, the panelists will describe their experiences as participants in a year long peer mentoring program and offer suggestions for best practices.

4:15 PM – 5:00 PM

Resiliency 545

Faculty: Leslie Oyama; Jeremy Branzetti, Joel Moll, Kevin Keller, Al'ai Alvarez, Robert Lamm, Katja Goldflam, Leah Bright, Kelly Williamson; Elise Lovell
545 Sessions are [5] talks with a common theme that are given in succession over 45 minutes. This 545 session is centered around topics related to Resiliency during Residency and throughout one's career.

Turn that Frown Upside Down

- List short and long term tools to change low program morale
- Cite examples of successful methods used to improve morale and build positive culture
- Develop a realistic timeline for culture change
- Identify factors that contribute to program morale and culture

Residency Retreat Redesign to Build Resiliency

- Outline the critical elements that must be included in a resiliency retreat for medical professionals
- Assemble a mini curriculum using the Stanford WellMD Professional fulfillment model
- Convert your previous retreat's goals and objectives
- Create and define metrics for success and budget to justify a return of investment

Point of Care Resiliency

- Review evidenced based resiliency practices that can be used in the workplace
- Review literature on drivers of burnout Resident Talent Showcase

Resident Talent Showcase

- Explore the opportunities to connect residents and faculty on a more personal level outside of medicine.
- Describe a number of ways to implement these ideas in a concrete way.
- Illustrate success stories of how connections have been made and the impact it has had on our medical teams.

Flipping the Switch — Moving from Burnout to Resilience

- Define resilience and its role in protecting against burnout
- Provide tools to grow resilience in your residents in order to promote personal fulfillment and professional satisfaction

Clerkship Directors in Emergency Medicine (CDEM)

8:00 AM – 8:50 AM

Evidence Based Recommendations for the Visiting Student Application Population

Faculty: Tony Zhang, David Gordon, Doug Franzen, Joshua Wallenstein, Lucienne Lufty-Clayton, Jamie Shandro

Obtaining Emergency Medicine away rotations has become increasingly challenging with an increase in specialty popularity and applications. Recent literature has shed light on how clerkship directors evaluate away applicants, but there is limited qualitative data from applicants.

9:00 AM – 9:30 AM**How to Find the Best Away Rotators (and How to Get Your Students Away Rotations)***Faculty: Hilary Fairbrother, Jonathan Giordano, Gowri Stevens*

This session will focus on how to attract, screen, and accept visiting medical students to your institution and how to place your home students in away rotations that maximize their application for residency.

9:30 AM – 10:00 AM**Making a Path for the Most Vulnerable: Best Practices in Advising the “At Risk” Applicant***Faculty: Lucienne Lutfy-Clayton, Kendra Parekh, Adam Kellogg, Tom Morrissey, Jamie Shandro, Mark Olaf, David Gordon*

We will briefly discuss advising the “at risk” applicant along with current evidence in advising. This will be followed by small group sessions to discuss advising strategies for applicants “at risk” of not matching and attempt to gain consensus on best practices when advising these applicants.

10:00 AM – 10:30 AM**No Match Monday***Faculty: Jaime Shandro, Jennifer Jackson, Mary Ann Edens, Adam Kellogg*

No Match Monday is a big challenge for all. This session will offer a pre-match risk assessment and advising checklist for at-risk students, as well as case-based advising strategies to use with unmatched students, including key considerations in the SOAP process as well as options beyond SOAP.

10:45 AM – 11:15 AM**The SVI and How to Have Your Students Ace It***Faculty: Jonathan Giordano, Hilary Fairbrother*

A didactic session on how to prepare students for the AAMC’s Standardized Video Interview (SVI) and residency interviews.

11:15 AM – 12:00 PM**A Guide to Mentoring URM, LGBT, and Women EM Applicants***Faculty: Sharon Bord, Kendra Parekh, Adam Kellogg, Jamie Hess, Ronnie Ren, Nicole Nemore, Nehal Naik, Joel Moll, Audrey Bickel, Caitlin Bailey*

This session will critically examine the challenges faced by underrepresented minority (URM), lesbian, gay, bisexual, transgender (LGBT), and female applicants and trainees and discuss how best to support and mentor these individuals to successful careers in EM.

1:30 PM – 2:00 PM**SLOE 101: An Introductory Course***Faculty: Cullen Hegarty, Tom Morrissey, Sarah Ronan-Bentle, Matt Ryan, Damon Kuehl, Kathy Hiller, Chrissy Babcock*

The Standardized Letter of Evaluation (SLOE) is a critical piece of the EM application process. Due to the value of the SLOE, it is important that new EM faculty get some basic coaching on the history of the letter, the form itself, and tips on how to write a great SLOE.

2:05 PM – 2:35 PM**Note Writing for Medical Students: How the CMS Changes Impact Their Notes***Faculty: Joseph House, Kathy Hiller, Miguel Arribas*

With the change in CMS regulations there are changes coming to the medical student’s role in the Emergency Department. One complaint students often have is the lack of being able to take ownership of their patients, which includes note writing. This session will discuss what programs are doing to train their students to write notes and how programs have reacted to the changes in CMS regulations.

2:35 PM – 2:45 PM**Medical Student Documentation Feedback***Faculty: Mark Olaf*

This session will present a novel tool to assist in the delivery of feedback to medical students regarding their documentation skills.

2:45 PM – 3:15 PM**CDEM Town Hall***Faculty: Luan Lawson, Kathy Hiller*

This session will cover any late-breaking topics impacting medical student education as well as provide an update on CDEM activities from the CDEM leadership.

3:30 PM – 4:10 PM**Teaching Diagnostic (Cognitive) Error to Medical Students***Faculty: Dan Mayer, Sorabh Khandelwal, Brendan Munzer, Michael Cole*

We must teach students and residents how cognitive errors lead to diagnostic error. Using the dual process theory of cognition this session will introduce methods of teaching prevention of diagnostic errors by reducing cognitive failures that can be exacerbated by practice conditions in the ED.

4:15 PM – 5:00 PM**345: Curricular Innovations in UME***Faculty: Kendra Parekh; Sharon Bord, Omar Guzman, Megan Henn, J. Scott Wieters*

This session will focus on curricular innovations, including incorporating a social EM curriculum evidence-based medicine curriculum, and gaming into your courses!

Emergency Medicine Association of Residency Coordinators (EMARC)**8:00 AM – 8:50 AM****Adulthood of the Millennial Intern***Faculty: Kristi Grall, Lori Barrett, Kelly Barringer, Rachel Dahms*

Conveying expectations to incoming residents becomes more and more challenging. We are not all winners, and cause and effect is very real. This team has developed strategies using anecdotes and humor to communicate residency expectations to a generation of learners who lack real life experiences.

8:00 AM – 8:50 AM**VSAS Updates and Tricks***Faculty: Jessica Burkhalter*

Clerkship Coordinators, UME coordinators lets talk VSAS.

8:00 AM – 8:50 AM**Program Coordinator Resources and How To Find Them***Faculty: Melody Cikalo; Dustin Hernandez*

New Program Coordinators will learn the various resources, contacts, and common information that is available to them.

12:00 PM – 1:30 PM**EMARC Coordinator Lunch — Hosted by EMRA***Faculty: Jana Ricker*

EMARC Coordinator lunch hosted by the Emergency Medicine Residents Association. Free to attend, prior registration required.

1:30 PM – 2:00 PM**Being a Residency Parent***Faculty: Carrie Chapman*

I have found myself to be the Residency Mom for 17 years picking up on subtle/unsobtle cues from the residents and collaborating with the Program Directors to promote wellness and a family atmosphere among the residents.

1:30 PM – 2:00 PM

A Year In the Life of a New Coordinator

Faculty: Yinka Cardoso; Taher Vohra

Residency administration has varying work through the year. A coordinator's 1st year is full of new skills and concepts. This creates unique onboarding and mentorship challenges compared to other jobs. We will describe the experience of a 1st year coordinator and successful mentorship strategies.

1:30 PM – 2:00 PM

Guess Who's Coming To Visit

Faculty: Melanie Pigott

With the competition for away rotations increasing how can we better serve the students? What might we do to increase the number of seats across the country? What are program expectations for application? How involved are clerkship coordinators in the screening/selection process?

2:05 PM – 2:45 PM

Change Management for the Program Coordinator

Faculty: Maria Moreira, Saadia Akhtar

Program Coordinators are poised to be change agents for residency programs. They have institutional memory and are fully dedicated to the administration of the program.

2:05 PM – 2:45 PM

The Examined Interview Day

Faculty: Benjamin Schnapp, Sarah Fallon

The interview day is a critical face of your residency: get it right and you'll recruit a class that will pay dividends to your program for years. What are applicants looking for when they visit? This collaborative workshop will discuss the literature and what programs can learn from applicants.

2:45 PM – 3:15 PM

Mentorship Guide for Your Program Coordinator

Faculty: Saadia Akhtar, Maria Moreira

Mentorship is important for growth and career advancement. The mentor/mentee relationship is very important, and the first step is identifying the right mentor. Additionally, there are skills that can help each of us succeed as mentors and mentees.

2:45 PM – 3:15 PM

Facilitating Feedback: Increasing Compliance with End of Shift Feedback

Faculty: Michael Gottlieb, Sreeja Natesan

Feedback is crucial to success in training. Facilitating feedback from residents, faculty, and nursing staff can be difficult to promote compliance and adherence. This lecture will highlight key strategies residency coordinators can use to engage members to be effective and timely in giving feedback.

2:45 PM – 3:15 PM

Orientation Station: How to Master the Art of Onboarding

Faculty: Chelsea Harrison PANEL: Sarah Fallon

Incoming Residents...what do you do?

- Review why Orientation is necessary.
- Establish a process
- Obtain tools to help you and your program orientate/ onboard your new interns

3:30 PM – 4:10 PM

Coach Others with S-W-O-T

Faculty: Denise Lesniak

SWOT analysis also applies to work. A coordinator is influenced by internal and external factors, and their impact leads to coordinator success. Just like Self-Study, coordinators can realize opportunities and mitigate threats. Coaching strategies lessen weaknesses and help strengths listed in SWOT.

3:30 PM – 4:10 PM

Table Talks for the New PC: 360 & Semi-Annual Evaluations, Didactics & ERAS Tips

Faculty: Amborsya Amlong PANEL: Kailey Bartrum; Raven-Olivia Jackson; Lisa Herald

Identify resources that will improve day to day work. Application of skills for the experts. Develop a larger community of resources/practices.

4:15 PM – 5:00 PM

Let's Acronym Together

Faculty: Denise Lesniak

There is an increase in listening and understanding when using communication formats. Often used acronyms like SBAR can be used by coordinators when communicating to program directors and other providers. The session demonstrates the benefits of the acronym formats when followed.

iMedEd

8:00 AM – 8:50 AM

Infographics Didactic & Workshop

Faculty: Teresa Chan, Alvin Chin, Simon Huang

Infographics are the latest rage in medical education as a form of presenting content that is easy to digest and memorable. Attend this hands-on session to learn what makes infographics such as powerful educational tool, how to an educator can create infographics, and how to best teach with them.

9:00 AM – 9:30 AM

More Than Meets the Eye: Virtual Reality in Medical Education

Faculty: Michael Barrie, Tim Koboldt, Warren Wiechman

Virtual reality is an emerging technology to provide immersive educational experiences. Programs will soon have the opportunity to provide high fidelity simulation on a lower budget using VR simulation. This hands-on session will demonstrate the latest and greatest in VR technology.

9:30 AM – 10:30 AM

Learning By Design: Running Your Own Design Thinking Workshop

Faculty: Teresa Chan, Mike Gottlieb, Rob Cooney, Alex Chorley

Design Thinking (DT) is a method for creating improvements in products or services that is growing in popularity within medical education. As a method, DT involves a more inclusive and experimentation-oriented technique. However, it can be overwhelming to try to run a session at your own institution without training. This session will discuss DT principles and how to effectively run a session at your institution. Attendees will leave the session ready to host their own DT session.

10:45 AM – 11:30 AM

Top i-Med Papers

Faculty: Jeff Riddell, Teresa Chan, Michael Gottlieb, Jon Ilgen

It can be challenging to keep up with the ever-increasing medical education literature. This session will highlight some of the top innovative and game-changing papers in medical education and discuss how to apply this to your practice.

11:30 AM – 12:00 PM

Critically-Analyzing Cutting Edge Literature: A Group Peer Review Breakout Session

Faculty: Jeff Riddell, Teresa Chan, Mike Gottlieb, Jon Ilgen

This session will be a hands-on group peer review workshop with medical education editors and topic experts performing group peer review on cutting-edge articles with a focus on innovation in medical education.

1:30 PM – 2:00 PM**Beyond the Lecture Hall: Novel Teaching Strategies Using Gamification**

Faculty: Dimitrios Papagagnou, Teresa Chan, Tony Zhang
Educators frequently look for ideas that embrace adult learning theory. The session examines gamification as a tool to design content for learners in EM. We will review best practices; describe how gamification can achieve these practices; and emphasize its ability to support knowledge application.

2:05 PM – 3:30 PM**So You Want to Record a Podcast?**

Faculty: Jeff Riddell, Andy Little
Podcasting is not just for those who love the sound of their own voice, it is an excellent way to teach! Whether you want to record a couple episodes to flip the classroom, or you want to create and sustain a medical education podcast for the masses, this workshop will show you how to make it happen.

2:05 PM – 3:30 PM**So You Want to Be a Public Speaker?**

Faculty: Mike Gisondi, Glenn Paetow
Public speaking can be scary — come listen to three public speakers in different stages of their careers share stories about how a few public speaking nightmares helped them overcome their fears. In this workshop, you will learn the skills needed to become the most excellent public speaker you know that you were always meant to be! This workshop will be a very engaging, very safe place to make mistakes and have fun with the process of developing a speech.

3:35 PM – 5:00 PM**So You Want to Write a Blog?**

Faculty: Jay Khadpe, Manny Singh, Jeffrey Hill, David Marcus
Blogs are all the rage these days. Come to this workshop to learn how to create and sustain a blog that can be used in medical education. Develop the skills to contribute to the growing world of FOAM and online medical education.

3:35 PM – 5:00 PM**So You Want to Enhance Your Slides?**

Faculty: Annahieta Kalantari, Rahul Patwari, Tyson Pillow
Ever hear of death by powerpoint? It doesn't have to be that way! Come to this workshop to learn how to get the umph back in your slides and wow your audience. Learn the skills to create dazzling slides and presentations.

Navigating the Academic Waters (NAW)**8:00 AM – 8:50 AM****Getting Started in Medical Education Research**

Faculty: Jaime Jordan
Recent literature has called for increased methodologic rigor in education research, however many educators lack formal research training. This session will be a practical overview of how to get started in medical education research, adhering to rigorous methodological standards.

9:00 AM – 10:00 AM**Meeting of the Minds: The Power of Creating a Mastermind Group**

Faculty: Sreeja Natesan; Charlotte Lawson; Glenn Paetow; Michael Gottlieb; PANEL: Gretchen Fuller; Fareen Zaver
Mastermind Groups are becoming a staple of "Near Peer" mentorship in the business world. Learn how Mastermind Groups can be leveraged to advance your career, as well as the career of your peers.

10:00 AM – 10:30 AM**Leadership Lessons from a Year with the Philadelphia Eagles**

Faculty: Yvonne Chow
Professional football and academic emergency medicine may not intersect at first glance. The speaker will share leadership lessons gained from a year of working with the Philadelphia Eagles football team, and discuss how they can be applied to advance a career in academic emergency medicine.

10:45 AM – 11:15 AM**So You Want to Play in the Big Leagues: Transcribing the Unwritten Rules of Academic Politics for Young Attendings**

Faculty: Matt Hall, Nicole Dubosh
Young attendings are fully prepared to care for clinically complex patients after graduation. However, success in an academic department requires more than just hard work. A host of unwritten rules and expectations, when followed, will allow young attendings to succeed in a complex academic world.

11:15 AM – 12:00 PM**Role and Impact of Gender and Ethnicity in Mentoring**

Faculty: Danya Khoujah, Tarlan Hedayati, Dhara Amin
This session will focus on issues in Cross-Gender and Cross-Ethnic Mentoring. This will include Identifying gender-based stereotypes in the mentoring relationship (including gender-based assumptions of both mentees and mentors), the impact of these perceptions on career development and advancement, and tips on overcoming gender bias in the mentoring relationship. We will also discuss practical tips to cultivate cross-cultural and cross-gender mentoring relationships, whether as a mentor, mentee or stakeholder.

1:30 PM – 2:00 PM**Anchors Up! Avoiding Cognitive Bias: Teaching Strategies for the Clinician Educator**

Faculty: Leslie Bilello, Nicole Dubosh, Jennifer Singleton
Physicians are often constrained by limited time and information and may rely on cognitive heuristics. Traditional didactics and bedside teaching often lack explicit instruction regarding such biases. We will teach strategic critical thinking skills to avoid cognitive biases and clinical errors.

2:05 PM – 2:35 PM**Turning Your Passions into Scholarship**

Faculty: Tim Koboldt, Michael Barrie
Developing a niche in academic EM is important. Learner needs and rapidly developing technologies provide new areas and roles for faculty. This session will describe combining your passions within and even outside of emergency medicine to cultivate a niche that is sustainable and enjoyable.

2:45 PM – 3:15 PM**"iTeach" — A Method for Teaching On Shift**

Faculty: David Masneri
"iTeach" is a method of effective on-shift teaching in the ED. "iTeach" provides a framework and tactics that can be utilized to better engage and educate targeted learners. Using the code letter "I", this method provides pearls to improve teaching success and learner satisfaction.

3:30 PM – 3:50 PM**Combining Powers: A Collaborative Conference Strategy**

Faculty: Ryanne Mayersak, David Jones
We designed a collaborative conference with our cardiology department to discuss issues that arise in the diagnosis and management of our combined cohort of patients. This session would describe how we implemented this curriculum, and how the model could be used for similar combined curricula.

3:50 PM – 4:10 PM

Morning Report—A Time to SNAP

Faculty: Cynthia Price

This session will describe a small group session we developed we term a SNAP group: Share, Nything and Process. The group is a collaboration between psychiatry residents and fellows at our institution that meets during morning report every other Friday to get our residents talking about scenarios that impact themselves or their patients during their shifts.

4:15 PM – 5:00 PM

Teaching to Talk so You can Talk to Teach

Faculty: Jason Wagner, Ed Ullman

Public speaking for many is a “necessary evil” in academic medicine. Many of us try to cram too much content into too little time. This session will discuss both theoretical as well as practical approaches to increasing audience retention of the content you deliver.

New Programs & Leaders (NPL)

8:00 AM – 8:50 AM

Due Process of Physicians and Resident Following Major Program Disruption

Faculty: Douglas Char, Mary Ann Edens, Linette Archer, Shawn London, Megan Healy, Melissa Platt

Multiple situations can disrupt clinical operations and impact a residency. Multiple employment models exist for faculty. What is the individual's due process rights? The hospital and RRC's responsibility to faculty and residents vary widely. Do you know your rights and avenues for due process?

1:30 PM – 2:35 PM

Coaching Residents: Competencies and Insights from Professional Coaches

Faculty: Melissa Platt, Magdalena Robak, Natasha Wheaton, Jeremy Branzetti, Dana Ferguson

Combined BP & NPL

While we often use the term “mentoring,” many of our contacts with residents as educational faculty are in fact, examples of coaching. This talk highlights the recent focus on “coaching” as a valuable construct for learner development in medical education. The speakers will cull through the best of coaching advice from the sports literature and relate it to the professional coaching of our residents. This talk goes straight to the source, gaining insight into coaching practices from professional coaches, drawing from advice and philosophies of famous Hall of Fame coaches.

2:45 PM – 3:15 PM

Innovations in Remediation and Mentoring

Faculty: Teresa Smith; Guy Carmelli

There is a variety of ways that an EM residency program director may remediate their learners in different ways. As learning methods evolve, so too should we see innovation in how we remediate learners when necessary. The goal of the current talk to discuss innovative ways to tailor remediation plans towards each learner's needs, to remediate learners based on their educational and career needs as well as their personality types.

3:30 PM – 3:50 PM

ESCAPED — Explore Synergy, Communication, and Partnership in Emergency Department

Faculty: Cami Pfennig

This session will explain how the ‘Escape Room’ experience can promote effective communication skills and enhance teamwork in the ED setting. The ESCAPED (Explore Synergy, Communication, And Partnership in Emergency Department) curriculum will be discussed to help others implement an analogous lesson plan at their home residency program. The speaker will present data to demonstrate how communication skills evolve after completing the ESCAPED experience.

3:50 PM – 4:10 PM

You're Leaving???

Faculty: Kerry McCabe, Jordan Spector

A program director's life is complex: maintaining accreditation, managing resident scheduling, ensuring educational value, being sensitive to wellness...when a resident leaves a program it affects every aspect of the job. Program Directors often do not talk about attrition and the complex impact it can have on our programs, residents, and faculty. That vacuum can feel lonely to PDs when they face such issues. The resources for dealing with attrition are unfamiliar and decentralized. This talk will provide learners with a plan for resident attrition, should it occur. The speakers will identify for filling a vacancy in the program and offer perspectives on how to navigate the consequences that may arise in these instances.

4:15 PM – 5:00 PM

New Programs and Leaders Survival Stories

Faculty: David Duong, Jordan Spector

Starting a new EM residency program or embarking as a fresh residency program director is likely accompanied by trials and tribulations. New waters are charted and one's leadership is put to the test. The new programs and leader's survival stories are a collection of our colleagues' experiences and cautionary tales of overcoming these hurdles in establishing a new program.

**Day Four
Wednesday, April 3, 2019**

Speciality

8:00 AM – 9:00 AM

Best of the Best

Faculty: Bo Burns, Jeffrey Siegelman

Combined all Tracks

The CORD community develops high quality research every year. This year we are going to highlight the very best abstracts submitted to the CORD research and innovations forums. In this session selected presenters will discuss their novel research from both undergraduate and graduate medical education. The session is intended for all tracks to attend.

9:00 AM – 10:15 AM

Program and Clerkship Director Survival Stories

Faculty: Sharon Bord, Madonna Fernandez, Tiffany Murano

Discussion of real-world challenging situations that Program Directors and Clerkship Directors have experiences.

Best Practices (BP)

10:30 AM – 11:10 AM

Developing a Curricular Toolkit for Broad Programmatic Dissemination

Faculty: Holly Caretta-Wyer, Sasha Tichter

The CORD Education Committee was tasked by the Board to develop curricular toolkits for dissemination to all EM programs. We will have performed a broad needs assessment, developed a toolkit template, and formulated a toolkit. The deliverables include being able to utilize a curricular toolkit framework for developing new curricula as well as the ability to provide feedback on our template and first toolkit for dissemination.

11:10 AM – 11:30 AM

Coaching and Mentorship 220

Faculty: Leslie Oyama, Jeremy Branzetti, Barbara Blok, Bonnie Kaplan, Page Bridges, Sarah Farris, Mark Pittman

CORD 220 sessions are [2] talks with a common theme that are given in succession over 20 minutes. The focus of this 220 session is to focus on Coaching and Mentoring.

Coaching faculty on new teaching processes in the ED: Implementing recommendations from a Resident Experience RPM

- Learn to use process improvement methodology to implement change in the educational environment of an academic ED
- Learn strategies for coaching faculty and staff to change their teaching behaviors in the ED
- Gain knowledge about using ED operational leadership to enhance the clinical learning environment

Creating a Productivity and Lateral Mentoring (PALM) Small Group

- Describe the functions and benefits of a Productivity And Lateral Mentoring group
- List the qualities you would want in your PALM group members
- Outline at least 3 career and/or wellness goals that you would want to address in a PALM group
- Describe the systematic process of identifying goals, creating deliverables, and reviewing them regularly as part of the PALM process

11:30 AM – 12:00 PM

Curricular Ideas 330

Faculty: Leslie Oyama; Jeremy Branzetti, Andrew King; Benjamin Ostro, Rochelle Zarzar, Glenn Paetow, Gannon Sungar

CORD 330 Sessions are [2] talks with a common theme that are given in succession over 30 minutes. The selected theme of this 330 session are Curricular Ideas.

A New Model for Morbidity and Mortality Conference: The Prospective Approach

- Discuss an alternative approach to morbidity and mortality conference with a stronger focus on cognitive autopsy and de-biasing strategies.
- Describe the advantages of a novel, prospective approach to analyze cases during didactics.
- Demonstrate how to effectively incorporate small group discussions into the morbidity and mortality conference as a method to increase resident engagement and solidify knowledge on cognitive errors and de-biasing strategies.

What is that Lurking in the Shadows — a Latent Risk Threat? Using Simulation as a Framework for Quality Improvement!

- Describe how in-situ simulation can be used as a means for quality improvement in your emergency department and discuss strategies for implementation.
- Describe latent risk threats (LRTs) and active errors and develop a framework for tracking and addressing the issues identified during these simulation activities, 3. Recognize that not conducting these quality improvement simulations could adversely affect your patient safety and outcomes, as there are many LRTs lurking — you just have to find them.

Evidence-Based Teaching: Applying Adult Learning Theory to Improve your Presentation

The goal of this session is to arm attendees with the foundational knowledge in adult learning theory to provide better presentations. Following completion of this session, attendees will be able to:

- Describe evidence-based principles in adult learning theory relevant to large group presentations
- Explain why traditional presentations often fail to capitalize on best practices in adult learning theory
- Discuss changes that can be made to their next lecture to maximize audience engagement and learning

12:00 PM – 12:30 PM

Leadership and Advancement 330

Faculty: Leslie Oyama, Jeremy Branzetti, Guy Carmelli, Theresa Tran, Neha Raukar

CORD 330 Sessions are [3] talks with a common theme that are given in succession over 30 minutes. The theme of this 330 session is Leadership and Advancement.

Residents as Leaders — Allowing Senior Residents to Get Maximally Involved

- Describe the increasing need for more and more senior resident involvement in leadership roles and residency education
- Discuss strategies for involving senior residents in leadership roles, thus preparing them for a career in academics and administration

Leader as Servant — Applying Servant Leadership in the ED

- Understand the theory of servant leadership
- Apply principles of servant leadership in the academic setting
- Gain tools to teach others to be servant leaders

Sitting at the Head of the Table

- Identify gender differences in communication and common communication practices and pitfalls. Identify individual expectations for leadership communication styles and how this may lead to gender stereotypes
- Discuss the importance of understanding the communication strategies used by different members of your team
- Identify communication strategies for developing leadership skills using gender neutral communication styles for residents and faculty

Navigating the Academic Waters (NAW)

10:30 AM – 10:50 AM

Make It Stick in Emergency Medicine

Faculty: Jordan Spector

An introduction of the learning principles from Peter Brown's highly renowned book "Make It Stick: The Science of Successful Learning" for EM educators.

10:50 AM – 11:10 AM

It's Like Herding Cats: Tips for Collaboration for Research Projects With Other Specialties

Faculty: Leah Bright, Katja Goldflam; Kamna Balhara

Collaboration with people in different specialties or non-physicians within your own can create productive working relationships and help expand your horizons. Finding the right fit when options are challenging. We will outline how to create a productive relationship.

11:10 AM – 11:30 AM

Adults are Just Big Kids: Learning Theories and Practical Ways to Improve Your Teaching

Faculty: Andrew Phillips, Tyson Pillow

What does learning sciences and cognitive psychology research on children tell us about adult learners? It turns out an awful lot! Explore how the mind and body are inseparable to encode knowledge and how context influences how and what we learn.

11:30 AM – 12:30 PM

Technology Enhanced Bedside Teaching — Practical Tips to Improve Teaching on Your Next Shift

Faculty: Tyson Pillow

Bedside teaching is essential to clinical training. Unfortunately, many educators struggle to incorporate bedside teaching, especially given the demands of the EMR, metrics, and lack of compensation. This session will give practical tips to incorporate technology to enhance bedside teaching.

AIRWAY: TRUE STORIES FROM THE ER



Sunday, March 31, 2019

8:00 PM - 10:00 PM

Palace Ballroom

2100 5th Ave

Seattle, WA 98121

This is a live storytelling event for EM physicians designed with the goals of creating community, embracing vulnerability, and normalizing difficult experiences common to the practice of emergency medicine.

Sponsored by CORD & RSA



Oral Abstract Presentations Schedule

Educational Soundbites

Monday, April 1, 2019, 12:00 – 1:00 PM, Columbia Ballroom A

Time	Title	Presenter
12:00 PM	A simulation-based curriculum on best practices for firearms safety	Andrew Ketterer, MD, MA
12:10 PM	Escape room: An innovative approach to teaching disaster preparedness to emergency medicine residents and medical students	Andrea Patineau, MD
12:20 PM	Cards to Promote Humanity: An Interactive Approach to Teaching Empathic Communication Skills	Christopher Richardson, MD
12:30 PM	A Structured Curriculum for Interprofessional Training of Emergency Medicine Interns	Ashley Rider, MD
12:40 PM	Affective, Cognitive, and Behavioral Outcomes from a Resident Personal Finance Curriculum Pilot Project	Eric Shappell, MD, MHPE
12:50 PM	Using Simulation to Engage and Educate During Monthly Emergency Medicine Residency Morbidity and Mortality Conferences	Megan Stobart-Gallagher, DO

Best of the Best Research

Wednesday, April 3, 2019 – 8:00 – 9:00 AM, Columbia Ballroom A

Time	Title	Presenter
8:00 AM	Can We Actually Improve Resident Wellness? Pilot Data from a Longitudinal Wellness Curriculum for Emergency Medicine Residents	Elizabeth Dubey, MD
8:10 AM	Comparison of the Standardized Video Interview and Interview Assessments of Professionalism and Interpersonal Communication Skills in Emergency Medicine	Laura Hopson, MD
8:20 AM	Faculty Perception of Medical Student Documentation in Emergency Medicine	Jason Lai, MD
8:30 AM	The Correlation of Emergency Medicine Residents' Grit and Achievement	Adriana Olson, MD, MAEd
8:40 AM	The Correlation of Emergency Medicine Residents' Grit and Non-Cognitive Characteristics	Nathan Olson, MD
8:50 AM	Impact of Interpolated Questions on Podcast Knowledge Acquisition and Retention: A Double-Blind, Multicenter, Randomized Controlled Trial	Michael Weinstock, MD

Index of Conference Abstracts

MODERATED POSTER SESSION • MONDAY, APRIL 1, 2019
5:00 – 6:30 PM • Hyatt Regency Seattle – Regency Ballroom B

STATION #1

5:20 PM	Rosh Review in the Clerkship: Utilization of a test-enhanced learning resource and performance on the National Board of Medical Examiners Emergency Medicine Advanced Clinical Exam	<i>Chelsea Bonfiglio, MD</i>
5:30 PM	Incidence of Resident Attrition in Emergency Medicine	<i>Madeline Brockberg, MD</i>
5:40 PM	Hiring For Attitude	<i>Stephanie Duckett, DO</i>
5:50 PM	A Novel and Well-Received Process for Tracking the ACGME 15 key index Procedures	<i>Frederick Fiessler, DO</i>
6:00 PM	The Anticipated Negative Impact on Emergency Medicine Faculty of the New ACGME Common Program Requirements	<i>Shawn Quinn, DO</i>

STATION #2

5:20 PM	A novel approach to remediating communication skills in “at-risk” residents using professional coaching.	<i>Ryan Bodkin, MD</i>
5:30 PM	Innovative evaluation tool: fast, robust and mobile engaging faculty in both written evaluations and verbal communication	<i>Raquel Harrison, MD</i>
5:40 PM	Transparency in the Culture of Assessment and Feedback: A Currently Opaque Environment and the Case for Resident Feedback Dashboards	<i>Raquel Harrison, MD</i>
5:50 PM	Assessing the Quality of Resident Verbal Hand-offs — Do you know what your residents are communicating?	<i>Julie Pasternack, MD, MS</i>
6:00 PM	Using Chart Stimulated Review to Develop Interns’ Medical Reasoning and Documentation	<i>Michael Zdradzinski, MD</i>

STATION #3

5:20 PM	When Less is More: A Novel Strategy for Improving Resident Evaluations	<i>Casey MacVane, MD, MPH</i>
5:30 PM	Examining the relationship between the AAMC Standardized Video Interview and Step 2 CS Subscores	<i>Bobby Naemi, Ph.D.</i>
5:40 PM	Increased space for comments on end-of-shift card associated with longer comments	<i>Jessie Nelson, MD</i>
5:50 PM	A Novel Method for Blinding Reviewers to Gender for the Purposes of Gender Bias Research	<i>Michael Pallaci, DO</i>
6:00 PM	Setting a Minimum Passing Standard for the Uncertainty Communication Checklist through Patient and Physician Engagement	<i>Dimitrios Papanagnou, MD, MPH</i>

STATION #4

5:20 PM	Standard Video Interview (SVI) Scores and Applicant Position on Residency Program List: A Correlation Study	<i>William Fraser, DO</i>
5:30 PM	Correlating SLOE rankings with EM match status: Is a lower third SLOE a no-go?	<i>Joseph Hansroth,</i>
5:40 PM	Graded Responsibility Among Emergency Medicine Residency Programs	<i>Jason Lai, MD</i>
5:50 PM	Impact of Ambient Background Noise on Sign-Out in the Emergency Department	<i>Connie Lorenzo, DO</i>
6:00 PM	Impact of an Emergency Department Resident Sign-out Checklist on Attending Assessments of Quality	<i>Connie Lorenzo, DO</i>

STATION #5

5:20 PM	Retrospective Review of Third Year Medical Students’ Clinical Evaluations Via Entrustable Professional Activities	<i>Jonathan Bronner, MD</i>
5:30 PM	Decreasing Stroke Alerts in the Emergency Department: A Lesson in Resource Utilization	<i>Derek DeWitt, BA</i>
5:40 PM	Comparison of AAMC Standardized Video Interview and the Electronic Standardized Letter of Evaluation	<i>Laura Hopson, MD</i>
5:50 PM	Mastery Multiple Choice Tests: Automatic Item Generation, Standard Setting, and Learner Performance	<i>Eric Shappell, MD, MHPE</i>
6:00 PM	How Do Emergency Medicine Residents Listen? A Cross-Sectional Analysis of Emergency Medicine Residents’ Preferred Listening Styles	<i>Mansoor Siddiqui, MD</i>

STATION #6

5:20 PM	Case-Linked Simulation Exercises Improve Resident Engagement in Palliative Care Discussions	<i>Ryan Guzik, DO</i>
5:30 PM	Mapping Emergency Medicine: Geographic Distribution of Emergency Medicine Clerkship and Residency Positions Based on 2016-2017 eSLOE Statistics	<i>Timothy Montrief, MD</i>
5:40 PM	Incorporating Rapid Cycle Deliberate Practice into Traditional Simulation-Based Medical Education	<i>Timothy Montrief, MD, MPH</i>
5:50 PM	Targeted Simulation-based Leadership Training in Graduate Medical Education	<i>Elizabeth Rosenman,</i>
6:00 PM	Escape the Trauma Room	<i>Snaha Sanghvi, DO</i>

STATION #7

5:20 PM	Transducer Effect on Image Quality and Acquisition in EFAST Exams by Novice Sonographers	<i>Barbara Beauchamp, MD</i>
5:30 PM	Ultrasound-Guided Serratus Anterior Plane (SAP) Blocks: An Emergency Medicine Residency Module Using a Homemade Phantom	<i>Kathleen Cowling, DO, MBA, MS</i>
5:40 PM	A Multimodal Curriculum on Intimate Partner Violence for Medical Students in an Emergency Medicine Clerkship	<i>Alanna Darling, MD</i>
5:50 PM	Use of Point-of-Care Ultrasound to Diagnose Achilles Tendon Rupture in Cadaver Models	<i>Josh Greenstein, MD</i>
6:00 PM	Single Versus Double Tourniquet Technique for Ultrasound-Guided Intravenous Catheter Insertion	<i>Jacob Price, MD</i>

STATION #8

5:20 PM	More is More: Drivers of the Increase in Emergency Medicine Residency Applications	<i>Robert Huang, MD</i>
5:30 PM	Doctors on the Hill: Initiation and Integration of Policy Advocacy in Emergency Medicine Residency Training	<i>Scott Pasichow, MD, MPH</i>
5:40 PM	The Zipperator! A Novel Model to Simulate Penile Zipper Entrapment	<i>Dale Till,</i>
5:50 PM	Rapid Cycle Deliberate Practice Simulation for Resuscitation Training of Medical Students	<i>Suzana Tsao, DO</i>
6:00 PM	Small-Scale High-Fidelity Simulation for Mass Casualty Incident Readiness	<i>Andrea Weiers, MD</i>

STATION #9

5:20 PM	Assessment of an Opt-Out Employee Assistance Program Assessment to Mitigate Burnout and Reduce Barriers to Seeking Mental Health Care in Emergency Medicine Residents	<i>Elizabeth Fruchter, MD</i>
5:30 PM	"I have nothing else to give": A qualitative exploration of emergency medicine residents' perceptions of burnout and compassion fatigue	<i>Aarti Jain, MD</i>
5:40 PM	Do Married Residents Place a Different Value on Wellness Initiatives than Single Residents?	<i>Brian Walsh, MD, MBA</i>
5:50 PM	Emergency Medicine Residents View Some Wellness Initiatives Differently Than Residents In Other Specialties	<i>Brian Walsh, MD, MBA</i>
6:00 PM	A Positive Depression Screen is Associated with Emergency Medicine Resident Burnout and is not Affected by the Introduction of a Wellness Curriculum	<i>Kelly Williamson, MD</i>

STATION #10

5:20 PM	Do Personality Characteristics Vary by Gender in Emergency Medicine Residents?	<i>Jaime Jordan, MD</i>
5:30 PM	Use of the "Step-Back" Method for Education Research Consultation at the National Level: A Pilot Study.	<i>Jaime Jordan, MD</i>
5:40 PM	3D Printed DIY US Femoral Nerve Block Task Trainer	<i>Patrick Palacios,</i>
5:50 PM	A Novel Standardized Rubric for Medical Student Emergency Medicine Oral Presentations	<i>Catherine Reynolds, MD</i>
6:00 PM	ECGStampede.com: An Exercise in ECG Interpretation and Triage	<i>Catherine Reynolds, MD</i>

STATION #11

5:20 PM	Speaker Training Pilot Program for Women in Health Care Decreases Fear Of Public Speaking	<i>Ashley Deutsch, MD</i>
5:30 PM	Viewing Trends in Emergency Medicine Residency Program Websites	<i>Sean Dyer, MD</i>
5:40 PM	Implementation of an Educational Dashboard with a Financial Incentive Improves Faculty Participation in Residency Evaluations	<i>Andrew Pugh, MBBS</i>
5:50 PM	Advancing Diversity in Emergency Medicine: The NYU EM Summer Fellowship for Underrepresented Minority Medical Students	<i>Audrey Bree Tse, MD</i>
6:00 PM	Securing an away rotation in Emergency Medicine: a survey on the applicant experience and perspective	<i>Xiao Chi Zhang, MD, MS</i>

STATION #12

5:20 PM	Foundations EKG I and EKG II: Open-Access Flipped-Classroom Critical EKG Curricula	<i>William Burns, MD</i>
5:30 PM	Assessing how a shared mental model influences team performance in blunt trauma resuscitation	<i>Ryan Gardner, MD</i>
5:40 PM	Reversing the Script: Peer-Based Teaching of Foundational Concepts in Emergency Medicine Using a FOAMed Curriculum	<i>Samuel Goldman, MD</i>
5:50 PM	Residents as Teachers: Applying the Foundations Model for Structured Near-Peer Education	<i>Kristen Grabow Moore, MD, MED</i>
6:00 PM	Peer-Guided Lightning Electrocardiogram Curriculum	<i>Jennifer Grodus, DO</i>

STATION #13

5:20 PM	An Innovative Meat Model Based Faculty Development Workshop to Increase Faculty Comfort with Performing Nerve blocks	<i>Simran Buttar, MD</i>
5:30 PM	Teaching and Evaluating Medical Students' Oral Presentations Skills in Emergency Medicine	<i>Kathryn Fisher, MD, MS</i>
5:40 PM	Just In Time: A Faculty Development Primer to Help Prepare Core Faculty for Clinical Teaching Shifts	<i>Jonathan Karademos, MD</i>
5:50 PM	Academic Promotion Workshop Series Enhances Emergency Physicians' Knowledge of and Experience with the Promotion Process	<i>Tania Strout, PhD, RN, MS</i>
6:00 PM	Emergency Department Thoracotomy Education Needs Assessment	<i>Hashim Zaidi, MD</i>

STATION #14		
5:20 PM	Email for Staff Education: The Good, The Bad, The Ugly	<i>Sara Hevesi, MD</i>
5:30 PM	A Unique Video-Review Curriculum to Improve Resident Education and Quality Measures in Cardiac Arrest	<i>Evan Kuhl, MD</i>
5:40 PM	A Novel Standardized Multimodal Model of Critical Care Assessment of Junior Residents	<i>Emberlynn Liu, MD</i>
5:50 PM	February Teach-Off Competition: A \$60 Teaching Intervention to Beat the Winter Blues	<i>Meghan McGrath, MD</i>
6:00 PM	The New Morbidity and Mortality Conference – A Prospective Approach	<i>Kushal Nandam,</i>
STATION #15		
5:20 PM	Sex and Gender Education in Emergency Medicine: A Residency-Based Curricular Audit	<i>Lauren Walter, MD</i>
5:30 PM	Current EM Resident Knowledge of Community Resources and the Impact of Structured Community Resource Visits	<i>Jeffrey Norvell, MD, MBA</i>
5:40 PM	Improving Residency Didactics Through Interdisciplinary Query	<i>Kara Sawyer, MD</i>
5:50 PM	Effect of a Pediatric Critical Care Bootcamp on the Knowledge and Confidence of Emergency Medicine Interns	<i>W. Gannon Sungar, DO</i>
6:00 PM	Using a Novel Online Relational Database Tool to Track Attendance and Increase Didactic Evaluations in Graduate Medical Education	<i>Christy Angerhofer</i>
STATION #16		
5:20 PM	Design of an Emergency Medicine Simulation-Based Assessment of Multiple Entrustable Professional Activities (EPAs) Within a Transitions to Residency Course	<i>Holly Caretta-Weyer, MD</i>
5:30 PM	A Needs Assessment for the Development of "Orphan" Topic Curricular Toolkits	<i>Holly Caretta-Weyer, MD</i>
5:40 PM	The "EM in 5" Curriculum: Learner and Presenter Perceptions	<i>Adriana Olson, MD, MAEd</i>
5:50 PM	A Resident-Driven Peer-to-Peer Coaching Model for Enhanced Patient Experience in the Emergency Department	<i>Reid Phillips, MD</i>
6:00 PM	Does an Educational Interactive Airway Lab Change Residents Choice of Airway and Comfort Level?	<i>Josef Thundiyl, MD, MPH</i>
STATION #17		
5:20 PM	A Novel Online Educational Series Improves Emergency Medicine Residents' Knowledge in Evidence Based Medicine (EBM)	<i>Nour Al Jalbout, M.D.</i>
5:30 PM	Scholarly Tracks: Not Just for Academic Careers	<i>Christian DeFazio, MD</i>
5:40 PM	Trends in Individualized Interactive Instruction Utilization and Correlation to In-training Examination	<i>Erich Heine, DO</i>
5:50 PM	Learning Experience Design (LED) in Health Professions Education: A Critical Review	<i>Lauren Massimo, MD, MS</i>
6:00 PM	Impact of a Mainly Online Mindfulness Course on Faculty and Trainee Wellness	<i>Lori Weichenthal, MD</i>
STATION #18		
5:20 PM	Burnout Scoring Using EMR	<i>Samantha Reeder, MD</i>
5:30 PM	Residency Families: The Development of a Peer Mentoring Program in an Emergency Medicine Residency	<i>Katie Tausch, MD</i>
5:40 PM	A Personal Crisis Management Plan for Residents	<i>Angela Chen, MD</i>
5:50 PM	Just checking in: a peer mentor program for emergency medicine residents	<i>Angelica McPartlin, MD</i>
STATION #19		
5:20 PM	Building interest in emergency medicine through a cadaver-based procedural skills workshop	<i>Charles Lei, MD</i>
5:30 PM	EM residents as mentors: Towards a curriculum on mentoring	<i>Charles Lei, MD</i>
5:40 PM	Notes vs Recall: Can 3rd year medical students benefit from obtaining and presenting an HPI without using notes?	<i>Lindsay MacConaghy, MD</i>
5:50 PM	Essentials of the Emergency Medicine Match Process: The Couples Match Addendum, on behalf of the CORD Advising Students Committee in EM	<i>Jose Nable, MD</i>
6:00 PM	Preparing for residency: A novel text-message tool to improve medical students' ECG interpretation skills	<i>Ryan VanNostrand, MD</i>
STATION #20		
5:20 PM	Creating a Culture of Resiliency and Support	<i>Caroline Schrodt, MD MSPH</i>
5:30 PM	Implementation of a "Family Orientation" as Part of New Resident Orientation	<i>Molly Hartrich, MD, MPH</i>
5:40 PM	A Resident-Built Order Set Improves Ease of Use and Efficiency	<i>Robert Turer, MD, MSE</i>

Poster Moderators

CORD would like to thank the following moderators for the 2019 Advances in Education Research & Innovation poster session.

Bo Burns, MD (Co Chair)
University of Oklahoma

Jeffrey Siegelman, MD (Co-Chair)
Emory University

Dhara Amin, MD
Cook County Emergency Medicine

Deena Bengiamin, MD
Loma Linda University Medical Center

Ryan Bodkin, MD
University of Rochester

Rich Bounds, MD
University of Vermont

Molly Estes, MD
Loma Linda University

Hilary Fairbrother, MD
McGovern Medical School, UTHealth at Houston

Abra Fant, MD, MS
Northwestern

Jenna Fredette, MD
Christiana Care Health System

Steven Hochman, MD
St Joseph's University Medical Center

Hans House, MD
University of Iowa

Shane Jennings, MD
University of Texas Health San Antonio

Elaine Josephson, MD
Lincoln Medical & Mental Health Center

Julianna Jung, MD
Johns Hopkins University SOM

Bryan Kane, MD
Lehigh Valley Health Network/USF MCOM

Jesse Kellar, MD
Spectrum Health Lakeland

Craig Krausz, MD
Saint Louis University

Christopher Lewandowski, MD
Henry Ford Hospital

Jennifer Li, MD
University Hospitals, Cleveland Medical Center

Simiao Li-Sauerwine, MD, MS
The Ohio State University

Elise Lovell, MD
Advocate Christ Medical Center

David Masneri, DO
Wake Forest School of Medicine

Peter Moffett, MD
Virginia Commonwealth University

Joel Moll, MD
Virginia Commonwealth University

Erik Nordquist, MD
Texas Tech University Health Sciences Center El Paso

Camiron Pfennig, MD, MHPE
Prisma Health/ University of SC Greenville

Todd Phillips, MD
John Peter Smith

Ava Pierce, MD
UT Southwestern Medical Center

Carlos Rodriguez, MD
Thomas Jefferson University Hospital

Stacy Sawtelle Vohra, MD
UCSF Fresno

Matthew Stull, MD
*University Hospitals-Cleveland Medical Center/
Case Western Reserve University*

Taku Taira, MD
LAC+USC

Brett Todd, MD
Beaumont

Michael Van Meter, MD
McGovern Med EM

Jennifer White, MD
Thomas Jefferson university hospital

Scott Young, DO
Madigan Army Medical Center

Events



Saturday, March 30

EMRA Leadership Academy (Invitation Only)

9a – 12p

Regency A, 7th floor

EMRA Committee Meetings

3p – 5p

Admin & Ops	Wishkah, 6th floor
Critical Care	Skagit, 6th floor
Education	Snohomish, 6th floor
Informatics	Yakima, 6th floor
Pediatrics EM	Wynoochee, 6th floor
Pre-Hospital and Disaster Medicine	Skykomish, 6th floor
Social EM	Nooksack, 6th floor
Sports Medicine	Hoh, 6th floor

5:15p – 7:15p

Diversity & Inclusion	Wynoochee, 6th floor
Health Policy	Nooksack, 6th floor
International	Wishkah, 6th floor
Research	Hoh, 6th floor
Toxicology	Twisp, 6th floor
Ultrasound	Skykomish, 6th floor
Wellness	Snohomish, 6th floor
Wilderness Medicine	Skagit, 6th floor



Sunday, March 31

8a – 5p

EMRA Hangouts
Sol Duc, 7th floor

8a – 5p

EMRA•Cast

8a – 12p

EMRA Medical Student Council Meeting
Hoh, 7th floor

9a – 10:30a

EMRA Public Hearing and Resolution Review
Tahuya, 5th floor
Let your voice be heard on important topics impacting EMRA, your training and our specialty.

2:45p – 4:45p

All EM Resident Organization Meeting (Invitation Only)
Sauk, 5th floor

5:30p – 7:30p

EMRA Quiz Show
Regency Ballroom B
Sponsored by Rosh Review
The EMRA Quiz Show is like a clinical and pop culture trivia event – EMRA style! Twelve EM programs compete in this high energy event to see who will have bragging rights. And there are not-to-be missed audience games too. Come join the fun.

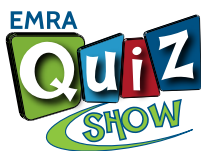

Monday, April 1

8a – 5p

EMRA Hangouts
Sol Duc 7th floor

8a – 5p

EMRA•Cast

7a – 8a

EMRA Rep Council Welcome Breakfast & Credentialing
5th floor Foyer

8a – 11a

EMRA Rep Council Meeting & Town Hall
Clearwater, 5th floor
Residency program reps debate resolutions relevant to EMRA, your training and our specialty.

12p – 3p

Chaos in the ED
Regency A, 7th floor
An All-Around Skills Competition Sponsored by PEER
You never know what you'll face when a patient walks through your emergency department doors, but the one thing you do know, is to expect the unexpected. Come to the Chaos in the ED to compete or watch! Shout out to ACOEP-RSO for sponsoring the championship round and to Simulab for the equipment. Sip on Bloody Mary's and Mimosas while you cheer.

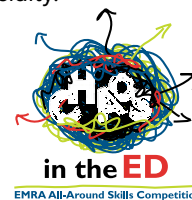

10p – 2a

EMRA Party at Nightclub
1426 Broadway
Sponsored by Envision Physician Services
Enjoy a great nightlife experience!

Tuesday, April 2

12p – 1:30p

EMRA Lunch with EMARC (Invitation Only)
Elwah B, 5th floor



Better TOGETHER

CORD Academic Assembly

SEATTLE, WASHINGTON

Vice Chair of Research

Rutgers, Robert Wood Johnson Medical School Department of Emergency Medicine

Rutgers is New Jersey's premiere public research university. With a \$1 billion commitment to invest in, support and drive groundbreaking, advanced research, the recent Rutgers and RWJ Barnabas Health integrated academic health system aims to further the university's reputation as a leader in academic health care and biomedical research.

Rutgers currently is ranked among the nation's top 20 public universities for research and development expenditures. Rutgers Robert Wood Johnson Medical School is first in the state for research and has steadily attracted increased NIH funding and grants in excess of \$1 million, as well as substantially expanded its clinical trials with the launch of a new, world-class adult clinical research center.

The Department of Emergency Medicine is seeking a Vice Chair of Research at the Associate Professor or Professor level, preferably tenure track. The Department's goal is to grow its research and scholarly output while building a nationally recognized research program. The Vice Chair will provide leadership and oversight of the research mission for the Department. Successful candidates will have a demonstrated track record of independently funded research, publication in high-impact, peer-reviewed journals, strong mentorship skills and clear evidence of promoting the academic careers of junior faculty. The Vice Chair must demonstrate expertise in leading research in EM and possess the interpersonal skills to engage, inspire and work across disciplines within a large, diverse organization.

Robert Wood Johnson Medical School and its principal teaching affiliate, Robert Wood Johnson University Hospital, comprise New Jersey's premier academic medical center. A 580-bed, Level 1 Trauma Center and New Jersey's Level 2 Pediatric Trauma Center, Robert Wood Johnson University Hospital has an annual ED census in excess of 90,000 visits. The department has a well-established, three-year Emergency Medicine residency program and an Emergency Ultrasound fellowship.

Qualified candidates must be ABEM/ABOEM certified/eligible. Salary and benefits are competitive and commensurate with experience.

For consideration, please send a letter of intent and a curriculum vitae to:

**Robert Eisenstein, MD, Chair, Department of Emergency Medicine
Rutgers Robert Wood Johnson Medical School**

1 Robert Wood Johnson Place, MEB 104, New Brunswick, NJ 08901

Email: Robert.Eisenstein@rutgers.edu • Phone: 732-235-8717 • Fax: 732 235-7379

Rutgers, The State University of New Jersey,
is an Affirmative Action/ Equal Opportunity
Employer, M/F/D/V.



Exciting Career Opportunity in Las Vegas

Academic Faculty: Assistant Research Director

The University of Nevada, Las Vegas (UNLV) Department of Emergency Medicine is seeking talented emergency medicine physicians with a passion for education to join the faculty of its **EM residency program**. Established in 2006, the 3-year EM program has an affiliation with the Air Force, and is comprised of **30 residents, including 2 active duty military residents** each year. We pride ourselves in the tremendous sense of camaraderie within our Emergency Department at **University Medical Center (UMC) of Southern Nevada**, which serves as the only **Level I Trauma Center and Burn Center** in the state of Nevada and the primary teaching site for the UNLV School of Medicine, with 10 residency programs. The Adult ED and Trauma Resuscitation Center have a combined **annual volume of 90,000**, serving a diverse patient population with conditions of high complexity and acuity, in addition to the **30,000 children evaluated annually** in the separate Pediatric ED.

This is a tremendous opportunity from both an academic and clinical perspective, for motivated individuals with an interest in a career in research and education, in a department that already includes a well-established research program with approximately 30 research assistants. Come join our faculty who are actively engaged in both education and community service, with a sincere dedication to training the next generation of emergency medicine providers. Residency faculty have an academic appointment within the UNLV School of Medicine, and are employed by US Acute Care Solutions.

For more information, visit usacs.com/careers
or call Darrin P. Grella at 844-863-6797. careers@usacs.com



fix

feminem 2019
idea exchange

**Registration is
open for FIX19!**

9.15.19 - 9.17.19
at The Grand Hyatt, NYC

Experience the moments.
Join the movement.

Learn More at
www.feminem.org



COUNCIL OF RESIDENCY DIRECTORS IN EMERGENCY MEDICINE

CALL FOR PAPERS

For *WestJEM*'s annual Special Issue in Educational Research and Practice

For more information go to:

<https://www.cordem.org/opportunities/westjem/>

Submit your articles to
[WESTJEM.com](https://www.westjem.com) today

All submissions due by 06/15/19

The Florida College of Emergency Physicians invites you to:

Symposium *by the* Sea 2019

August 1-4, 2019 at Boca Raton Resort & Spa in Boca Raton, FL

Approved for AMA PRA Category 1 Credits™

FEATURING:

- SimWARS
- Research Poster Abstract Competition
- Resident Case Presentation Competition
- Florida Chapter of EMRA Reception & Meeting

Residents receive a discounted registration rate



Learn more & register at fcep.org



Live.



Work.



Balance.



Get the Best of Both Worlds.

Your work is your passion. But it's not your whole life.

Join a system that supports your need to balance work and home life. You can find great dining, art, entertainment, and culture in our cities, as well as peace and quiet in our rural areas. With opportunity for advancement and great schools and colleges nearby, it's a great place to grow your career and your family.

Join our Emergency Faculty team!

- UPMC Emergency Residency Program coming July 2020 (six to eight residents per year)
- Employed position at UPMC Pinnacle Harrisburg
- Highly competitive compensation and a great benefits package

Site Director Opportunity also available.

EOE. UPMC Pinnacle is an Equal Opportunity Employer.

Contact

Rachel Jones, MBA, FASPR
Physician Recruiter
rajones@pinnaclehealth.org
717-231-8796

UPMC Pinnacle

UPMCPinnacle.com/Providers

{ Job Opportunities }

Division Chief, Pediatric Emergency Medicine
EMS Fellowship Director/EMS Medical Director
Assistant Medical Director
PEM/EM Core Faculty
Vice Chair Research Emergency Medicine

What We're Offering:

- We'll foster your passion for patient care and cultivate a collaborative environment rich with diversity
- Salaries commensurate with qualifications
- Sign-on bonus
- Relocation assistance
- Retirement options
- Penn State University Tuition Discount
- On-campus fitness center, daycare, credit union, and so much more!

What We're Seeking:

- Experienced leaders with a passion to inspire a team
- Ability to work collaboratively within diverse academic and clinical environments
- Demonstrate a spark for innovation and research opportunities for Department
- Completion of an accredited Emergency Medicine Residency Program
- BE/BC by ABEM or ABOEM
- Observation experience is a plus

What the Area Offers:

We welcome you to a community that emulates the values Milton Hershey instilled in a town that holds his name. Located in a safe family-friendly setting, Hershey, PA, our local neighborhoods boast a reasonable cost of living whether you prefer a more suburban setting or thriving city rich in theater, arts, and culture. Known as the home of the Hershey chocolate bar, Hershey's community is rich in history and offers an abundant range of outdoor activities, arts, and diverse experiences. We're conveniently located within a short distance to major cities such as Philadelphia, Pittsburgh, NYC, Baltimore, and Washington DC.



FOR ADDITIONAL INFORMATION PLEASE CONTACT:



Susan B. Promes, Professor and Chair, Department of Emergency Medicine c/o Heather Peffley,
Physician Recruiter, Penn State Health Milton S. Hershey Medical Center
500 University Drive, MC A595, P O Box 855, Hershey PA 17033
Email: hpeffley@pennstatehealth.psu.edu
or apply online at: hmc.pennstatehealth.org/careers/physicians

Penn State Health is committed to affirmative action, equal opportunity and the diversity of its workforce. Equal Opportunity Employer – Minorities/Women/Protected Veterans/Disabled.

MASTER OF ACADEMIC MEDICINE

CREATING POSITIVE CHANGE ONE FELLOW AT A TIME!



Build Your Career Options WITH THE USC MASTER OF ACADEMIC MEDICINE

- Online live (synchronous) weekly classes with one week onsite in February each year.
- Build your skills as a teacher, leader, scholar, and mentor.
- Work each week with fellows from around the country, along with faculty from multiple other specialties.
- Complete the program in 2 years, 2 classes per semester.

Many successful graduates completed the program when they were EM fellows –

EM Education Fellows: Arlene Chung, Program Director, Malmonides; Jordana Haber Hazan, U Nevada Las Vegas; Joan Noelker, Washington U; Albert Kim, Washington U; TJ Welniak, U Nebraska

EM Simulation Fellows: Danielle Hart, Program Director, Hennepin County; Glenn Pawtow, Hennepin County; Kim Sokol, current student, Kaweah Delta

EM Global Medicine Fellow: Michelle Feltes, Stanford

Visit our website for more information:

keck.usc.edu/academic-medicine-program



The MACM program taught me everything I needed to know to be a medical educator. Not only did we learn about medical education and research, but we also delved into professional development, which has been invaluable in my leadership positions. I chose the MACM instead of one of the other MHPE programs because it seemed to cover everything the MHPEs covered, but the electives seemed more applicable to someone who wanted to be a program director in the future. I was able to gain invaluable skills, many of which I use on a regular basis. I strongly recommend this program for anyone interested in medical education, and especially for those interested in program leadership.

Danielle E Hart, MD, MACM

Program Director, Emergency Medicine Residency, Hennepin County Medical Center, Minneapolis, MN

APPLY TODAY! CLASSES BEGIN AUGUST 14, 2019

Keck School of Medicine of USC



Journal of Education & Teaching *in* Emergency Medicine

A journal of CORD

Education

We believe that all learners should benefit from active learning.
We are an online, open access, journal-repository for EM educators in all major topic areas.

Scholarship

We believe educators should advance through the scholarship of their educational work.
JETem gives you the opportunity to publish & distribute your outstanding, scholarly academic work so that it may be widely distributed.

We accept a variety of content
Submit your scholarship today!



visualem



small groups



tbl



simulation



lecture



oral boards



podcasts



curriculum



innovations

www.jetem.org

Contact the JET*pack* at: JETemOnline@gmail.com

The editorial team at JETem wants to thank all our authors, reviewers and users!
We have published 10 issues with over 241 articles from almost 300 innovative and dedicated educators just like you! Over **46,000 users browsed** the journal last year. Since our launch users have **downloaded YOUR content over 23,000 times**. As our numbers continue to grow, we thank you for your support, innovation, and dedication to teaching!



published by

eScholarship University of California



Residencies are not designed to teach finance... *let us manage financial training for you.*

With 22 years of experience transitioning house-staff in to practice, Integrated Wealthcare created the **Confident Transition Plan™**, a proven system that provides residents and fellows clear navigation through the financial transition in to practice. In addition to providing this training, Integrated Wealthcare:

- Has designed multiple Capstone Programs for medical students, residencies, and fellowships
- Provides tax, insurance, investment and life planning models customized to your particular program and demographic
- Supports 1,200 emergency physician clients in 43 states
- Has fostered a 12-year relationship with ACEP and EMRA as contributors, speakers, and sponsors.

Find out how to add Integrated WealthCare to *your* training program

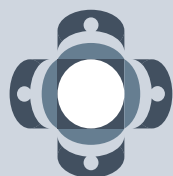

**INTEGRATED
WEALTHCARE**

Collaborative Wealth Management
for the Medical Community

T: 866.694.6292 | www.iwcglobal.net

3211 Shannon Road, Ste. 420, Durham, NC 27707 | 1300 Division Road, Ste. 203, West Warwick, RI 02893
9 Farmington Place, Newtown, PA 18940

Securities offered through Triad Advisors, LLC, Member FINRA/SIPC. Investment Advisory Services are offered through Capital Wealth Management, LLC, a registered investment advisor. Capital Wealth Management, LLC and Triad Advisors, LLC are not affiliated.



EM COACH

**FIRST ARTIFICIAL INTELLIGENCE-BASED STUDY TOOL
THAT WORKS HARDER SO YOU STUDY SMARTER**

- EXAM-STYLE QUESTIONS
- HIGH YIELD TEXTBOOK
- ENGAGING LECTURES
- INNOVATIVE VISUAL AIDS

EM Coach only delivers what you need to study to reinforce your success on the EM boards



We are different because we have:

- **CUSTOMIZED AND FASTER LEARNING:** Personalized study plans, progress trackers, and lessons adapted to your needs using Artificial Intelligence
- **DEDICATED RESEARCH TEAM:** Theory-driven, research-supported, question-based learning with comprehensive explanations for all answer choices
- **MIMICS THE BOARDS:** Full-length, timed practice exams with a plethora of ABEM-formatted review questions
- **ANYWHERE AND EVERYWHERE:** Available for iOS, Android, desktop, tablet, mobile, home, office, on the go, and everywhere in between
- **AFFORDABLE PRICING:** Twice the features, half the price with a money-back guarantee and CME credit
- **PROGRAM AND CLERKSHIP DIRECTOR PORTAL:** Exclusive Director Portal to assign studying (and see if they were completed) and track learners' progress

**LET THE COACH DIAGNOSE AND TREAT YOUR WEAK SPOTS
THIS IS THE EM BOARDS EDUCATION REDEFINED**

Emergency Medicine & Toxicology Faculty

Rutgers Robert Wood Johnson Medical School

The Department of Emergency Medicine at Rutgers Robert Wood Johnson Medical School, one of the nation's leading comprehensive medical schools, is currently recruiting Emergency Physicians and Medical Toxicologists to join our growing academic faculty.

Robert Wood Johnson Medical School and its principal teaching affiliate, Robert Wood Johnson University Hospital, comprise New Jersey's premier academic medical center. A 580-bed, Level 1 Trauma Center and New Jersey's only Level 2 Pediatric Trauma Center, Robert Wood Johnson University Hospital has an annual ED census of greater than 90,000 visits.

The department has a well-established, three-year residency program and an Emergency Ultrasound fellowship. The department is seeking physicians who can contribute to our clinical, education and research missions.

Qualified candidates must be ABEM/ABOEM certified/eligible. Salary and benefits are competitive and commensurate with experience. Sub specialty training is desired but not necessary.

Please send a letter of intent and a curriculum vitae to:

**Robert Eisenstein, MD, Chair, Department of Emergency Medicine
Rutgers Robert Wood Johnson Medical School**

1 Robert Wood Johnson Place, MEB 104, New Brunswick, NJ 08901

Email: Robert.Eisenstein@rutgers.edu

Phone: 732-235-8717 - Fax: 732 235-7379

Rutgers, The State University of New Jersey, is an Affirmative Action/ Equal Opportunity Employer, M/F/D/V.



Riverside Regional Medical Center Newport News, VA

is accepting applications from qualified academic emergency physicians to join an energetic faculty for a new emergency medicine residency program expected to begin in July 2020 contingent upon ACGME accreditation. The program is led by an experienced academic emergency physician with a long history of exceptional educational and leadership accomplishments to include prior Program Director, Designated Institutional Official, and almost 30 years of military service.

Riverside Regional Medical Center is a busy, high acuity, Level II Trauma Center, Stroke and Chest Pain Center located in beautiful, historic Newport News Virginia that has a long history of community service and graduate medical education, hosting one of the first Family Medicine training programs in the country. The institution has put its full support behind this residency program, adding to its longstanding Family Medicine, Obstetrics and Gynecology, and Transitional year programs.

To hear first hand about our program while at the CORD conference, contact Kevin Knoop, MD, Program Director (text: 757 532-3997; email: kevin.knoop@rivhs.com)



Contact us at
recruitment@umem.org
or 667-214-2060

UMEM is an EOE/AE



Academic and Community Openings for BE/BC Emergency Physicians

Vibrant and varied career possibilities in academic and community settings in the Baltimore metropolitan area as well as near Washington, DC, Philadelphia and Maryland's stunning coastline.

Live and work in an urban, suburban or rural community, in an atmosphere that encourages a work/life balance.

Current EM Practice Opportunities

Downtown Baltimore – Volumes from 21 to 66K

North of Baltimore – Volumes from 32 to 65K

Eastern Shore – Volumes from 15 to 37K

DC Suburbs – Volumes from 34 to 60K

Our supportive team approach in the delivery of high quality patient care features:

- Dedicated fast track and intake units staffed by Family Practice physicians and PAs
- ED scribes and medical information systems
- Stroke centers & STEMI programs
- Ultrasound programs with bedside US machines
- Advanced airway equipment including GlideScope®

Very Generous Compensation and Benefit Package

- Additional incentive compensation
- Medical, dental, vision and life insurance
- Employer-paid CME, PTO and 401K safe harbor retirement plan
- Employed-paid malpractice insurance with full tail coverage



MATT KAUFMAN, MD, FACEP
EMERGENCY MEDICINE

ENVISION PHYSICIAN SERVICES OFFERS...

THE OPPORTUNITY TO GRAVITATE TO ANY SETTING I WANT

Featured Leadership and Staff Positions

- **Community Medical Center**
Toms River, NJ
Residency Program Director
- **Kingwood Medical Center**
Kingwood, TX
Residency Program Director
- **New York Presbyterian Queens**
Flushing, NY
Assistant Program Director
- **Oak Hill Hospital**
Tampa Bay, FL
Assistant Program Director
Director of Ultrasound
Core Faculty
- **Osceola Regional Medical Center**
Kissimmee, FL
Assistant Program Director
Ultrasound Fellowship Director

Reasons to Choose Us

- Physician-led practices supported by fellow physicians within our local, regional and national level infrastructure
- Best-in-class professional development and leadership programs with long-term career pathways
- Collegial environment that strengthens clinical engagement and encourages work-life balance

Coast-to-Coast Positions

- Academic • Community • Pediatric
Rural • Urban • Travel Team

877.226.6059 or success@evhc.net
EnvisionPhysicianServices.com



Bring the power of PEER assessments to your residency training program

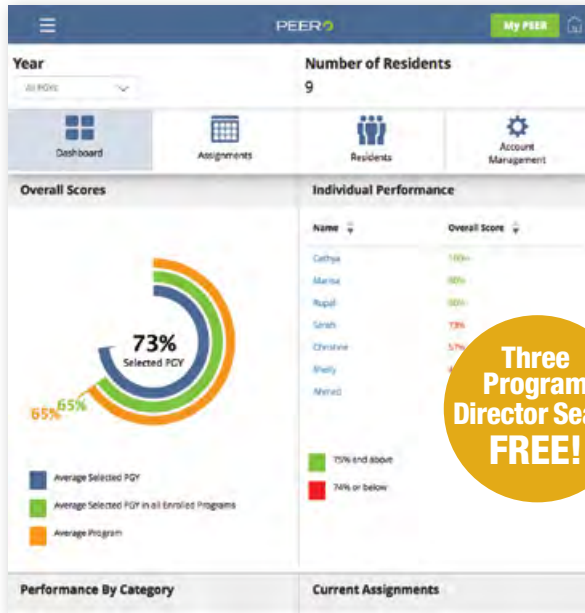

PEER for Residency Programs!

Sign up your program, buy memberships for your residents and faculty at a discounted annual fee, then assign and monitor tests to augment your program curriculum.

\$95 each seat
OR LESS

Three Program Director Seats FREE!

Learn more at acep.org/PEER

PEER

Approved for AMA PRA Category 1 Credit™

1528_0219

Buy One for Yourself or Give as a Gift!



Bring 'em All
Chaos. Care. Stories from
Medicine's Front Line.

Hardcover | Member \$75
NonMember \$95 | Resident \$55

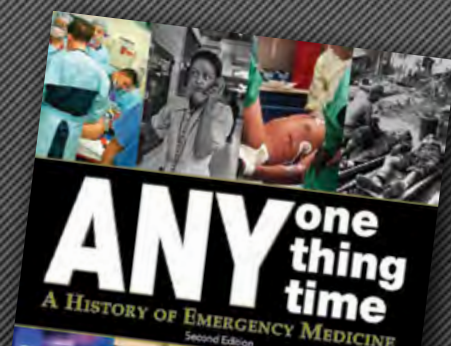

Anyone, Anything, Anytime
A History of Emergency Medicine
2nd Edition

Softcover | Member \$60 | NonMember \$120 | Resident \$30
Hardcover | Member \$75 | NonMember \$150 | Resident \$40

bookstore.acep.org

Call ACEP Member Care Center at 844.381.0911 for bulk pricing.

AMERICAN COLLEGE OF EMERGENCY PHYSICIANS
BOOKSTORE

1529_0219

*A Place to Teach & Practice.
A Place to Call Home.*

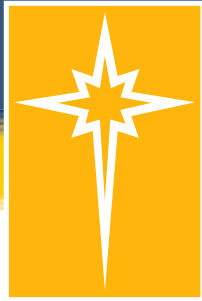

St Luke's
UNIVERSITY HEALTH NETWORK

www.sluhn.org



In joining St. Luke's University Health Network, you will enjoy:

- Team-based care with well-educated, dedicated support staff
- Teaching, research, quality improvement and strategic development opportunities
- A culture in which innovation is highly valued
- Exceptional compensation package
- Rich benefits package, including malpractice, health and dental insurance, CME allowance

EMERGENCY MEDICINE RESIDENCY PROGRAM DIRECTOR

St. Luke's University Health Network, the region's largest, most established health system, a major teaching hospital, and one of the nation's 100 Top Hospitals is seeking an Emergency Medicine Residency Program Director to start a new Emergency Medicine Residency Program, based out of St Luke's Anderson Campus. The Founding Program Director will be responsible for leading, administering, and supervising all aspects of the Emergency Medicine Residency Program in accordance with the ACGME Program Requirements and Institutional Goals and Objectives.

The Program Director will have dedicated time for administrative, educational, strategic, and research initiatives and provide oversight and development of the Emergency Medicine Residency program and participate in our academic mission through our Temple/St. Luke's School of Medicine partnership. In addition, the Program Director will be expected to maintain a clinical practice with allocated time to develop and lead the residency program. Program Director and Clinical duties will be split to accommodate.

Qualifications

- Must be Board Certified in Emergency Medicine,
- Must have a minimum of 3 years of experience as a Core Faculty member in an ACGME –accredited Emergency Medicine program
- Must be clinically active in Emergency Medicine
- Have previous leadership/administrative experience and strong team building skills
- Willing to combine Administrative and Diagnostic (teaching) Responsibilities (50/50)
- Candidates with recent scholarly activity such as peer-reviewed funding, publication of original research or review articles in peer-reviewed journals, chapters in textbooks, publications or presentation of case reports or clinical series at scientific society meetings, or participation in national committees and/or educational organizations highly encouraged to apply.

About St. Luke's Anderson Campus

Opened in 2011, Anderson Campus consists of a four-story, 108 bed acute care hospital (soon to be 210 beds), state-of-the-art cancer center, a 75,000 square foot ambulatory surgical center, and medical office building. The 32 bed Emergency Department currently has 45,000 patient visits per year. Private inpatient rooms are state-of-the-art with the latest technology and amenities. Consisting of over 500 acres, Anderson Campus also includes auxiliary gardens, a two-mile walking path, and a pond with a fountain and sitting area to promote wellness.

About St. Luke's University Health Network

We are the region's largest, most established health system with 10 hospitals spanning 9 counties. In partnership with Temple University, St. Luke's created the region's first Medical School. Repeatedly, including 2017, St. Luke's has earned Truven's 100 Top Major Teaching Hospital. St. Luke's is a member of the AAMC Council of Teaching Hospitals and a Regional Branch Campus and major affiliate of Temple University School of Medicine. To learn more about St. Luke's, please visit us at www.SLUHN.org

About the Lehigh Valley

Set amid gentle hills and charming country sides, Lehigh Valley, PA is home to Allentown, Bethlehem, and Easton, as well as dozens of small towns and picturesque boroughs, parks, trails, and waterways. Steeped in pre-Colonial, Early American, and industrial history, the region's storied past became its uplifting present, bestowing visitors anything from crayons and craft beer to Martin Guitars and museums, covered bridges, and nationally-recognized events like Musikfest and Christkindlmarkt.

The Lehigh Valley is in close proximity to NYC, Philly, and DC. Outstanding higher education facilities include Lehigh University and Moravian College. Cost of living is low and coupled with minimal congestion; choose among a variety of charming urban, semi-urban and rural communities your family will enjoy calling home. There is easy access to outdoor activities like skiing, snowboarding, white water rafting, and zip lining. The Lehigh Valley encompasses three unique cities in one suburban area. For more information please visit www.discoverlehighvalley.com.

If you are interested in learning more about the position, please contact: Drea Rosko, Physician Recruiter, St. Luke's University Health Network, Drea.Rosko@sluhn.org, 484-526-4132

My Health My Hospital.



COUNCIL OF RESIDENCY DIRECTORS IN EMERGENCY MEDICINE

NYC

MARCH 8 - 11, 2020

#CORDAA20

MEET US IN THE BIG

